

Table of Contents

▶ See page

Statement of Line	
Traxx and Tiles	310
Planning	
Overview	311
Product Information	312
Application Guidelines	313
Pricing & Specifying	
Traxx Components	315
Tiles	316
Presentation Tools	322
Traxx End Trim and Trim Caps	324
Traxx Trim Channels and Vertical Cable Managers	325
Traxx Brackets and Spacers	326

Statement of Line

➤ See page

Finishes & Materials 527

Overview 311

Product Information 312

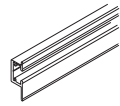

Traxx

➤ See page 315 to specify.

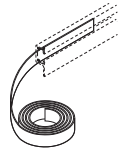

Fastener Concealment

➤ See page 315 to specify.

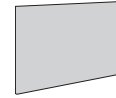

Fabric Tiles

➤ See page 316 for tile compatible with Panel systems.
➤ See page 317 for tile compatible with Conferencing Solutions.

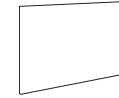

Marker Board Tiles

➤ See page 318 for tile compatible with Panel systems.
➤ See page 319 for tile compatible with Conferencing Solutions.

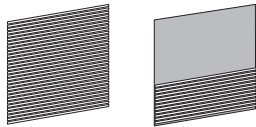

Slat Tiles

➤ See pages 320–321 to specify.

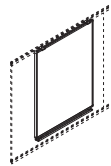

Flexboards

➤ See page 322 to specify.

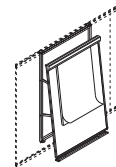

Extendable Flip Chart Holder

➤ See page 322 to specify.



Swivel Marker Board

➤ See page 322 to specify.



Overhead Projection Board

➤ See page 322 to specify.



Presentation Rail

➤ See page 323 to specify.

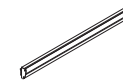

Flip Chart Holder

➤ See page 323 to specify.

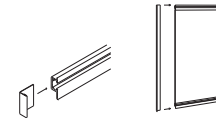

End Trim

➤ See page 324 to specify.



Trim Caps

➤ See page 324 to specify.

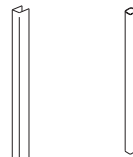

Trim Channels and Vertical Cable Manager

➤ See page 325 to specify.

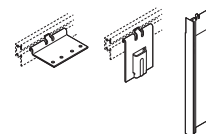

Attachment Bracket Kits

➤ See page 326 to specify.

Traxx & Tiles

Overview

Related Products:

Presentation Tools

➤ See page 322.

Vertical cable manager is available to route cords. It is available in fabric or black plastic.

➤ See page 325.

Paper Management/ Work Tools

➤ See the Perks Price List.

Traxx is a unique horizontal rail system that attaches to existing architecture, allowing free, off-module placement of Kimball Office components. Place storage, worksurfaces, tiles and panels wherever you need them.

Upper Traxx can be mounted to correspond with appropriate panel heights or at 80"H for conference room applications.

Tiles mount between upper and lower Traxx to add functionality to the workspace.

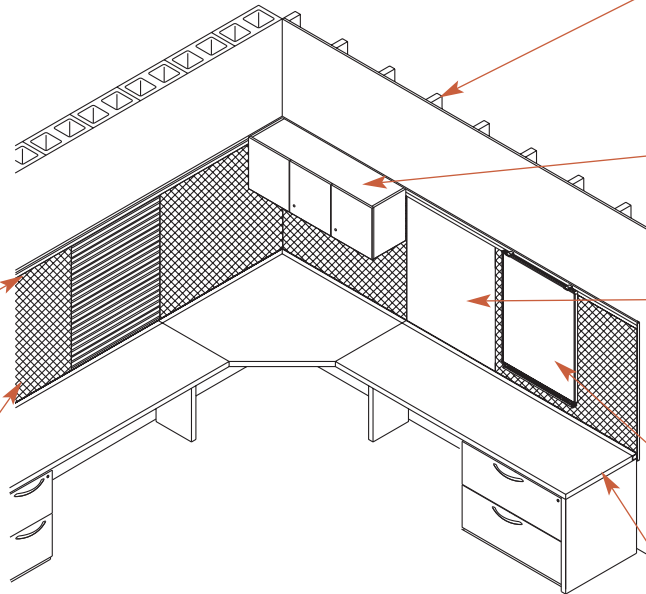

Traxx can be mounted to most interior walls, including steel or wood stud walls, masonry block, or solid masonry walls.

Overhead storage can be mounted to upper Traxx.

Fabric and standard marker board tiles can be scribed in the field to meet individual requirements.

Presentation tools hang from upper Traxx and slide along rail.

Worksurfaces can be mounted to lower Traxx.

Traxx & Tiles

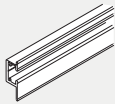

Finishes and Materials:

Traxx

- Paint

End Trim

- Paint, except 499 Satin

Trim Cap

- Paint
- Wood finishes

Tiles

- Fabric
- Slat: paint
- Marker board:
 - 409M Icey White or
 - 483M Off White

Trim Channels

- Fabric
- Paint

Traxx and Tiles Product Information

Details

Traxx is available in lengths of 72" and 144", and can be scribed in the field. Traxx models include:

- Two Traxx (72" or 144")
- Four splice plates

Tiles are available in fabric, slat, or marker board models. Fabric and standard marker board tiles can be scribed in the field. Tile models include:

- Tile
- Two trim channels

Marker board tiles add convenient, erasable writing space and are ideal for offices, training rooms, and conference areas. Available in laminate or magnetic porcelain.

Slat tiles offer flexibility in placement of work tools. Selecting the slat tile with fabric above is an economical alternative when overhead storage will be used.

Two trim channels, standard with each tile, provide an expansion joint, wire manager attachment, and compensate for out-of-plumb walls. Additional trim channels are available, if required, for tiles that have been scribed in the field.

Connections

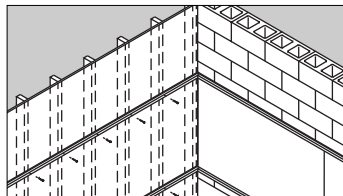

Traxx are mounted horizontally permitting complete tie-in to all studs.

No additional blocking is required to support Traxx, if walls are designed and built to specifications outlined.

➤ See page 313 for application guidelines.

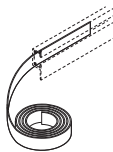

Fastener concealment is used to conceal splice plates and fasteners. It does not interfere with mounted components and does not require any additional tools for installation. Fastener concealment is available in vinyl or felt. Vinyl must be specified when using presentation tools.

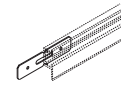

Splice plates are required to align two sections of Traxx inline or when turning corners. They are easily modified in the field to accommodate angles or corners.

Planning Factors

Traxx can be mounted at any height if not corresponding to other products.

➤ See page 313 for mounting heights to correspond to panel applications.

To custom paint Traxx in the field, specify 480 Antique White. Schedule delivery to precede the rest of the order to provide time for painting. Traxx should be lightly sanded before painting. Enamel based paints are recommended.

➤ See page

Finishes & Materials 527

Overview 311

Application Guidelines 313

Related Products

Traxx panel starter kits allow attachment of a panel anywhere along Traxx.

Full end trim is available to finish the end of tile between upper and lower Traxx.

Panel-height full end trims are available for use with Traxx panel starter kit.

Single end trim finishes the end of a single Traxx rail, if stopping Traxx short of an intersecting wall.

Trim cap slips into the top ledge of the upper Traxx to provide continuity with panel heights.

➤ See page 324.

Traxx & Tiles

Application Guidelines Traxx

Recommended Fasteners:

Selection and purchase of the proper attachment fasteners for your wall conditions is the responsibility of the installer.

Type and Size	Commercial Model #
---------------	--------------------

Steel studs (1/2" to 3/4" drywall)

Hilti® Toggler® anchor toggle bolts, 1/4"-20 x 2" grade 5 bolts	374494
-----------------------------------------------------------------	--------

Wood studs (1/4" to 1/2" drywall)

Meets or exceeds ANSI/ASME B18.6.4 and SAE J933.

Pan head sheet metal screw	10-2 PHPMS
----------------------------	------------

Solid Masonry

Crown Bolt lag shields	1/4" x 1 1/2"
------------------------	---------------

Buildex Tapcon concrete anchor screw	1/4" x 2 3/4"	24385
--------------------------------------	---------------	-------

Masonry Block

Hilti Toggler anchor toggle bolts, 1/4"-20 x 2" grade 5 bolts	374494
---------------------------------------------------------------	--------

Crown Bolt lag shields	1/4" x 1 1/2"
------------------------	---------------

Buildex Tapcon concrete anchor screw	1/4" x 2 3/4"	24385
--------------------------------------	---------------	-------

► See assembly instructions on www.kimballoffice.com.

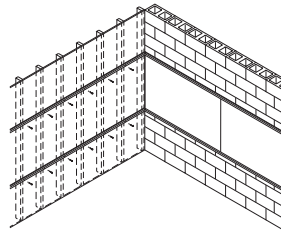

Fasteners must tie in directly to the substructure of a structural wall for proper attachment of Traxx. Kimball Office defines a structural wall as a loadbearing wall constructed of materials such as poured concrete, concrete block, or studs.

Minimum Requirements:

- Wood studs must be nominal 2" x 4" minimum.
- Metal studs must be "C" channel, 20 gauge minimum thickness.
- Metal or wood studs must be on centers no greater than 24" and have a maximum height of 14' restrained at floor and ceiling.
- Interior walls must be designed to resist not less than a force of 5 lbs. per sq. ft. applied perpendicular to the wall. The deflection of such walls under a load of 5 lbs. per square foot shall not exceed 1/240 of the span for walls with brittle finishes and 1/120 of the span for walls with flexible finishes (per International Building Code sections 1604.4 and 1607.13).

- Traxx may not extend more than 6" beyond the last solid attachment point.
- Minimum width of Traxx that can be attached to a wall is 16" mounted to studs 16" apart.
- If an overhead is being mounted, the minimum width for Traxx is 24" with the Traxx being centered on studs 16" apart, so as not to extend more than 6" beyond the last solid attachment point.

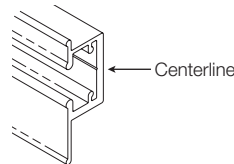

Determine proper position of Traxx using centerline of lower Traxx as a reference point.

Actual mounting height can be varied to meet specific needs; however, undersurface storage height must be considered.

Variations in the floor surface (peaks and valleys) should be considered, especially where horizontal placement is critical.

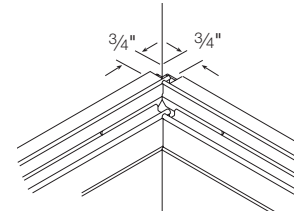

Traxx extends 3/4" from the wall. This dimensional loss should be considered when space planning for components, when Traxx are being used on 2 or more walls of a space.

When planning components for the entire length of the wall, total length of storage components should be a minimum of 1 1/2" less than the total length of the wall. Filler panels may be specified to fill any remaining space.

Select worksurfaces and tiles can be field scribed to fit space.

In fixed wall Traxx applications, choose your tile height based on your specific application. Consider the height of the cabinet and clearance between the bottom of the overhead and the worksurface.

Traxx Installation Heights:

Traxx should be installed at heights to correspond with the appropriate application.

Compatible with Cetra and Xsite:

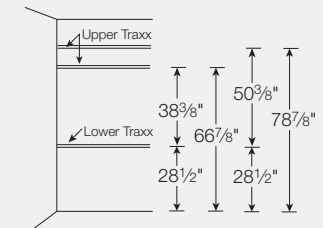

Overhead Cabinets	66 7/8"H
Worksurfaces	28 1/2"H
Conferencing Solutions	78 7/8"H

Note: 37"H tiles coordinate with Cetra and Xsite 68"H applications.

Compatible with Interworks EQ:

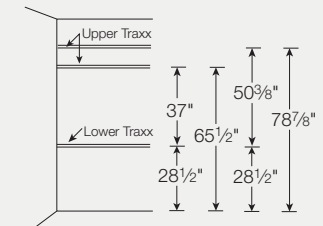

Overhead Cabinets	65 1/2"H
Worksurfaces	28 1/2"H
Conferencing Solutions	78 7/8"H

Note: 36"H tiles coordinate with Interworks EQ 66"H applications.

Presentation Tools Product Information

Finishes and Materials:

Flexboard Fabric

- 2913 Charcoal Grey
- 2914 Natural Linen

Flexboard Marker Board

- White porcelain

Presentation Rail

- Black only

Flip Chart Holders/ Board Frames

- Anodized aluminum

Details

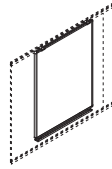

Flexboards provide tackable fabric or marker board surfaces that can be positioned easily for your convenience. Flexboards hang from the center reveal of the upper Traxx. They can also hang off the top edge of the upper Traxx; however, the anti-dislodgement feature will be inactive in this position.

Flexboards are reversible. They are available in fabric/marker board and marker board/ marker board combinations. Marker board surfaces are porcelain/magnetic.

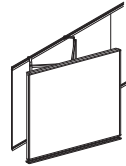

Swivel marker board hangs from the upper Traxx channel which allows it to pass over flexboards, flip chart holder, and extendable flip chart holder. It will swivel 45° for maximum flexibility. Pen holder is included.

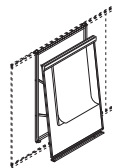

Extendable flip chart holder provides an ergonomically correct surface for writing on flip charts. It pulls out from the wall at a 20° angle for access and to allow pages to be flipped over the back of the chart and remain attached. Ships with one pad of paper. There is a marker board surface beneath the pad. Concealed rollers on extendable flip chart holder are standard to hold any pages that are torn from the flip chart pad. Pen holder is included.

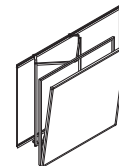

Overhead projection board has a glare resistant surface and can be tilted at a 45° angle to achieve the best possible image. Board also swivels 45°. It hangs from the upper Traxx channel which allows it to pass over flexboards, flip chart holder, and extendable flip chart holder.

Anti-dislodgement feature on all boards keeps them in place as they move along the Traxx. Boards may be used with or without tiles.

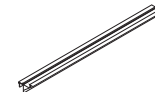

Presentation rail is 36"W and can be used on the lower Traxx to hold presentation materials. It can also be used as an eraser tray.

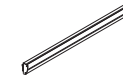

Flip chart holder hangs on upper Traxx and can be repositioned easily. It holds standard size flip chart pads. Pegs are adjustable. Flip chart holder is equipped with concealed rollers to hold any pages that are torn from the flip chart pad.

► See page

Finishes & Materials 527

Overview 311

Application Guidelines 313

Traxx & Tiles

Traxx Components

K = Kwik Office model available.
 ➤ See the Kwik Office Price List.

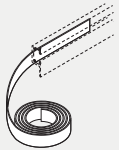
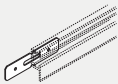
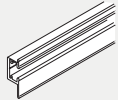

D	W	H	Model	Description	Price
Traxx					
1 1/16"	72"	2"	TTWMT72 K	Set of 2 Traxx and 4 splice plates	\$282
	144"		TTWMT144 K	Set of 2 Traxx and 4 splice plates	404
Splice Plates					
	4"	7/8"	TTSP04 K	Set of 4 splice plates	\$8
Fastener Concealment					
	700"	7/8"	TTCS	One roll; black vinyl	\$47
	700"	7/8"	TTFCF K	One roll; black felt	27

Related Products

- Trim channels
 ➤ See page 325.
- Overhead mounting brackets
 ➤ See page 507.

➤ See page

Finishes & Materials	527
Statement of Line	310
Product Information	312

Specifying Tips:

- Traxx can be cut to size in the field.
- One 700" roll of fastener concealment accommodates 2 sets of Traxx.
- **IMPORTANT:** Specify vinyl fastener concealment when using presentation tools.
- Four splice plates are included with each set of Traxx. Specify additional splice plates only if needed for your installation.

How to Specify:

Traxx

- ① Model
- ② Finish price group:
STD = Group 1
STD M = Group M (+10%)
- ③ Finish designator

Sample (base model underlined):

① TTWMT72 ② STD ③ 488

Splice Plates and Fastener Concealment

- ① Model

Traxx & Tiles

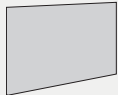

Fabric Tiles Compatible with the Heights of Panel Systems

K = Kwik Office model available.
➤ See the Kwik Office Price List.

D	W	H	Model	Fabric Price Grade				
				A or COM	B	C	D	E
37"H Tiles (Compatible with Xsite and Cetra Panels)								
1/2"	12"	36 7/8"	FIT1237A	\$228	\$244	\$256	\$273	\$299
	18"		FIT1837A	249	270	285	307	340
	24"		FIT2437A	261	284	301	325	362
	30"		FIT3037A	303	331	351	380	424
	36"		FIT3637A	314	342	362	391	435
	42"		FIT4237A	322	350	370	399	443
	48"		FIT4837A	333	361	381	410	454
	54"		FIT5437A	368	396	416	445	489
	60"		FIT6037A	371	408	435	473	533
36"H Tiles (Compatible with Interworks EQ Panels)								
1/2"	12"	35 1/2"	HIT1236A K	\$220	\$245	\$264	\$286	\$348
	18"		HIT1836A K	244	269	288	310	372
	24"		HIT2436A K	253	278	297	319	381
	30"		HIT3036A K	295	320	339	361	423
	36"		HIT3636A K	304	329	348	370	432
	42"		HIT4236A K	314	339	358	380	442
	48"		HIT4836A K	324	349	368	390	452
	54"		HIT5436A K	356	381	400	422	484
	60"		HIT6036A K	360	409	447	492	617

Standard:

- 2 matching trim channels

Related Products:

- Trim channels
➤ See page 325.

➤ See page

Finishes & Materials	527
Statement of Line	310
Product Information	312

Specifying Tips:

- **IMPORTANT:** 37"H tiles correspond to 68"H Xsite and Cetra panels; 36"H tiles correspond to 66"H Interworks EQ panels.
- Tiles can be field scribed. Additional trim channels should be specified separately if additional tiles are created.
- Railroaded fabric option is available on 37"H tiles compatible with Xsite tiles. Fabric is turned 90° and applied to the tile when this option is selected.

How to Specify:

- ① Model
- ② Railroaded fabric option (include for 37"H tiles):
Y = Yes
N = No
- ③ Fabric grade
- ④ Fabric number

Sample (base model underlined):

① FIT1237A ② Y ③ B ④ 2202

Traxx & Tiles

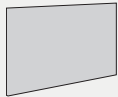

Fabric Tiles Compatible with Conferencing Solutions

D	W	H	Model	Fabric Price Grade				
				A or COM	B	C	D	E
49"H Tiles								
1/2"	12"	48 7/8"	FIT1249A	\$257	\$273	\$285	\$302	\$328
	18"		FIT1849A	286	307	322	344	377
	24"		FIT2449A	300	323	340	364	401
	30"		FIT3049A	351	379	399	428	472
	36"		FIT3649A	355	383	403	432	476
	42"		FIT4249A	369	397	417	446	490
	48"		FIT4849A	381	409	429	458	502
	54"		FIT5449A	423	451	471	500	544
	60"		FIT6049A	425	462	489	527	587

Standard:

- 2 matching fabric trim channels

Related Products:

- Trim channels
➤ See page 325.

➤ See page

Finishes & Materials	527
Statement of Line	310
Product Information	312

Specifying Tips:

- Tiles can be field scribed. Additional trim channels should be specified separately if creating additional tiles.
- See Caseloads and Tables price list for Conferencing Solutions.

How to Specify:

- ① Model
- ② Railroaded fabric option:
Y = Yes
N = No
- ③ Fabric grade
- ④ Fabric number

Sample (base model underlined):

① FIT1249A ② Y ③ B ④ 2202

Traxx & Tiles



Marker Board Tiles Compatible with the Heights of Panel Systems

D	W	H	Laminate		Magnetic Porcelain	
			Model	Price	Model	Price
37"H Tiles (Compatible with Xsite and Cetra Panels)						
1/2"	24"	36 7/8"	FIT2437M	\$462	FIT2437PMM	\$483
		30"	FIT3037M	463	FIT3037PMM	485
		36"	FIT3637M	519	FIT3637PMM	560
		42"	FIT4237M	559	FIT4237PMM	562
		48"	FIT4837M	678	FIT4837PMM	773
		54"	FIT5437M	682	FIT5437PMM	781
		60"	FIT6037M	686	FIT6037PMM	790
36"H Tiles (Compatible with Interworks EQ Panels)						
1/2"	24"	35 1/2"	HIT2436M	\$448	—	—
		30"	HIT3036M	449	—	—
		36"	HIT3636M	505	—	—
		42"	HIT4236M	543	—	—
		48"	HIT4836M	657	—	—
		54"	HIT5436M	661	—	—
		60"	HIT6036M	667	—	—

Standard:

- 2 complementary trim channels

Related Products:

- Trim channels
▶ See page 325.

▶ See page

Finishes & Materials	527
Statement of Line	310
Product Information	312

Specifying Tips:

- **IMPORTANT:** 37"H tiles correspond to 68"H Xsite and Cetra panels; 36"H tiles correspond to 66"H Interworks EQ panels.
- Magnetic porcelain marker board is standard in white.
- Tiles can be field scribed (excluding porcelain marker board). Additional trim channels should be specified separately if additional tiles are created.
- Expo or Expo2 dry erase markers are recommended for use on marker boards. Low-odor dry erase markers are not recommended, as they may leave undesirable results when erased.

How to Specify:

- ① Model
- ② Laminate finish designator (omit for porcelain marker board):
409M Icey White
483M Off White

Sample (base model underlined):

① FIT2437M ② 409M



Marker Board Tiles

Compatible with Conferencing Solutions

D	W	H	Laminate		Magnetic Porcelain	
			Model	Price	Model	Price
49"H Tiles						
1/2"	24"	48 7/8"	FIT2449M	\$538	FIT2449PMM	\$588
		30"	FIT3049M	541	FIT3049PMM	591
		36"	FIT3649M	603	FIT3649PMM	678
		42"	FIT4249M	654	FIT4249PMM	746
		48"	FIT4849M	791	FIT4849PMM	930
		54"	FIT5449M	795	FIT5449PMM	1110
		60"	FIT6049M	801	FIT6049PMM	1214

Standard:

- 2 complementary trim channels

Related Products

- Trim channels
➤ See page 325.

➤ See page

Finishes & Materials	527
Statement of Line	310
Product Information	312

Specifying Tips:

- Tiles can be field scribed (excluding porcelain marker board). Additional trim channels should be specified separately if creating additional tiles.
- Magnetic porcelain marker board is standard in white.
- Expo or Expo2 dry erase markers are recommended for use on marker boards. Low-odor dry erase markers are not recommended, as they may leave undesirable results when erased.
- See Caseloads and Tables price list for Conferencing Solutions.

How to Specify:

- ① Model
- ② Laminate finish designator (omit for porcelain marker board):

409M Icy White
483M Off White

Sample (base model underlined):

① ②
FIT2449M 483M

► See page

Finishes & Materials	527
Statement of Line	310
Product Information	312

Traxx & Tiles

Slat Tiles

Compatible with the Heights of Xsite or Cetra Panels

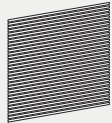

D	W	H	Model	Price
37"H Tiles				
<i>37"H Full Slat</i>				
1/2"	24"	36 7/8"	FIT2437SS37P	\$1172
	30"		FIT3037SS37P	1179
	36"		FIT3637SS37P	1346
	42"		FIT4237SS37P	1348
	48"		FIT4837SS37P	1497

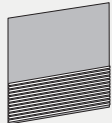

D	W	H	Model	Fabric Price Grade				
				A or COM	B	C	D	E
<i>16"H Slat and 21"H Fabric</i>								
1/2"	24"	36 7/8"	FIT2437SS16	\$949	\$967	\$981	\$1000	\$1030
	30"		FIT3037SS16	955	973	987	1006	1036
	36"		FIT3637SS16	1090	1108	1122	1141	1171
	42"		FIT4237SS16	1092	1110	1124	1143	1173
	48"		FIT4837SS16	1214	1232	1246	1265	1295

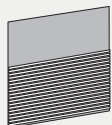

<i>24"H Slat and 13"H Fabric</i>								
1/2"	24"	36 7/8"	FIT2437SS24	\$1057	\$1071	\$1081	\$1095	\$1118
	30"		FIT3037SS24	1062	1076	1086	1100	1123
	36"		FIT3637SS24	1211	1225	1235	1249	1272
	42"		FIT4237SS24	1214	1228	1238	1252	1275
	48"		FIT4837SS24	1347	1361	1371	1385	1408

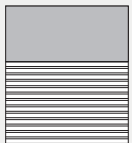

Grooves are 1/2" each
Slats are 1"H

Standard:

- 2 matching trim channels

Specifying Tips:

- 37"H tiles correspond to 68"H Xsite and Cetra panels.
- One single monitor arm can be accommodated per full slat tile.

Related Products

- Trim channels
► See page 325.
- Work tools and monitor arms
► See the Perks Price List.

How to Specify:

Full Slat Tiles

- ① Model
- ② Finish price group:
STD = Group 1
STD M = Group M (+10%)
- ③ Finish designator

Slat and Fabric Tiles

- ① Model
- ② Trim channel option:
N = Fabric trim channel
P = Painted trim channel
- ③ Railroaded fabric option:
Y = Yes **N** = No
- ④ Fabric grade
- ⑤ Fabric number
- ⑥ Finish price group:
STD = Group 1
STD M = Group M (+10%)
- ⑦ Finish designator

Sample (base model underlined):

① ② ③ ④ ⑤
FIT2437SS16 Y B 2202
⑥ ⑦
STD 462

► See page

Finishes & Materials	527
Statement of Line	310
Product Information	312

Traxx & Tiles

Slat Tiles Compatible with the Heights of Interworks EQ Panels

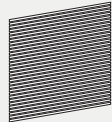

D	W	H	Model	Price
36"H Tiles				
<i>36"H Full Slat</i>				
1/2"	24"	35 1/2"	HIT2436SS36P	\$ 1172
	30"		HIT3036SS36P	1179
	36"		HIT3636SS36P	1346
	42"		HIT4236SS36P	1348
	48"		HIT4836SS36P	1497

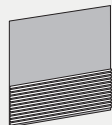

D	W	H	Model	Fabric Price Grade				
				A or COM	B	C	D	E
<i>16"H Slat and 20"H Fabric</i>								
1/2"	24"	35 1/2"	HIT2436SS16	\$949	\$967	\$981	\$1000	\$1030
	30"		HIT3036SS16	955	973	987	1006	1036
	36"		HIT3636SS16	1090	1108	1122	1141	1171
	42"		HIT4236SS16	1092	1110	1124	1143	1173
	48"		HIT4836SS16	1214	1232	1246	1265	1295

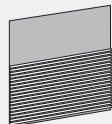

<i>24"H Slat and 12"H Fabric</i>								
1/2"	24"	35 1/2"	HIT2436SS24	\$1057	\$1071	\$1081	\$1095	\$1118
	30"		HIT3036SS24	1062	1076	1086	1100	1123
	36"		HIT3636SS24	1211	1225	1235	1249	1272
	42"		HIT4236SS24	1214	1228	1238	1252	1275
	48"		HIT4836SS24	1347	1361	1371	1385	1408



Grooves are 1/2" each
Slats are 1"H

Standard:

- 2 matching trim channels

Specifying Tips:

- 36"H tiles correspond to 66"H Interworks EQ panels
- One single monitor arm can be accommodated per full slat tile.

Related Products

- Trim channels
► See page 325.
- Work tools and monitor arms
► See the Perks Price List.

How to Specify:

Full Slat Tiles

- ① Model
- ② Finish price group:
STD = Group 1
STD M = Group M (+10%)
- ③ Finish designator

Slat and Fabric Tiles

- ① Model
- ② Trim channel option:
N = Fabric trim channel
P = Painted trim channel
- ③ Fabric grade
- ④ Fabric number
- ⑤ Finish price group:
STD = Group 1
STD M = Group M (+10%)
- ⑥ Finish designator

Sample (base model underlined):

① ② ③ ④
HIT2436SS16N B 2202
 ⑤ ⑥
 STD 462

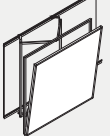
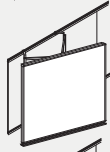
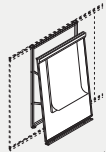
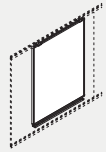

Standard:

- Mounting hardware
- One pad of paper with extendable flip chart holder

D	W	H	Model	Description	Price
Flexboards					
<i>Marker/Marker</i>					
1 1/8"	35 7/16"	32"	TPT3632MMFALUM	With pen holder	\$869
1 1/8"	35 7/16"	46 5/8"	TPT3647MMFALUM	With pen holder	1162
<i>Marker/Fabric</i>					
1 1/8"	35 7/16"	46 5/8"	TPT3647MFF	With pen holder	\$1196
Extendable Flip Chart Holder with Pen Holder					
3 3/8"	31 1/2"	48 3/8"	TPT3248EFCH		\$1513
Swivel Marker Board with Pen Holder					
2"	47 3/4"	52 1/2"	TPT4853SMBALUM		\$2499
Overhead Projection Board					
2"	52 1/2"	52 1/2"	TPT5353OPBALUM		\$2499
2"	62 1/2"	62 1/2"	TPT6363OPBALUM		2821

► See page

Finishes & Materials	527
Statement of Line	310
Product Information	314

Specifying Tips:

- Fabric flexboards are tackable.
- Marker boards are white porcelain/magnetic.
- Extendable flip chart holder holds standard size flip chart paper. Pegs are adjustable.
- Extendable flip chart holder has a white porcelain/magnetic marker board below pad.
- All boards hang off upper Traxx and can be used with or without tiles.
- Frames are anodized aluminum.
- Expo or Expo2 dry erase markers are recommended for use on marker boards. Low-odor dry erase markers are not recommended, as they may leave undesirable results when erased.

How to Specify:

Marker/Fabric Flexboard

- ① Model
- ② Fabric:
2913 = Charcoal Grey
2914 = Natural Linen

Sample (base model underlined):

① ②
TPT3647MFF2913

Marker/Marker Flexboard, Extendable Flip Chart Holder, Swivel Marker Board, and Overhead Projection Board

- ① Model

Presentation Tools, continued

► See page

Finishes & Materials	527
Statement of Line	310
Product Information	314

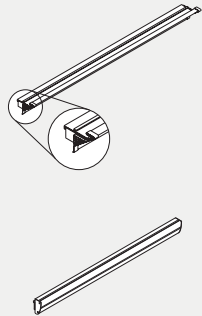

<i>D</i>	<i>W</i>	<i>H</i>	<i>Model</i>	<i>Description</i>	<i>Price</i>
Presentation Rail					
3"	36"	2½"	FPR36	Cinder	\$125
Flip Chart Holder					
1¾"	31½"	2¾"	FM3203FCH	Anodized aluminum	\$465

Specifying Tips:

- End caps on presentation rails allow two rails to be joined together to create a longer display surface. A smooth transition is accomplished by removing one end cap and inserting the exposed rail into the end cap of another rail.

How to Specify:

- ① Model

Standard:

- End caps on presentation rail

End Trim and Trim Caps

K = Kwik Office model available.
 ▶ See the Kwik Office Price List.

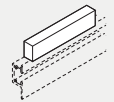
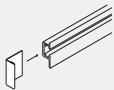

D	W	H	Model	Description	Price
Full End Trim					
<i>For use with 37"H Cetra Tiles</i>					
1 1/16"	1 1/2"	40"	TTET40	For use on upper and lower Traxx	\$82
<i>For Use with 36"H Interworks EQ Tiles</i>					
1 1/16"	1 1/2"	39"	TTET39 K	For use on upper and lower Traxx	\$78
<i>For Use with 49"H Conferencing Solutions Tiles</i>					
1 1/16"	1 1/2"	52"	TTET52	For use on upper and lower Traxx	\$95
Single End Trim					
1 1/16"	1 1/2"	2"	TTET02 K	For use on single Traxx	\$32
Trim Caps					
9/16"	72"	15/16"	TTC72W	Wood	\$93
			TTC72P	Paint	93

▶ See page

Finishes & Materials	527
Statement of Line	310

Specifying Tips:

- Specify end trim for finish detail when end of Traxx and tiles are exposed.
- Trim cap slips into the top ledge of the upper Traxx to add finishing detail for Traxx applications.
- Full end trim may be used for finish detail when end of wall mounted overhead is exposed.

How to Specify:

- ① Model
- ② Finish price group:
STD = Group 1
STDM = Group M (+10%)
- ③ Finish designator

Sample (base model underlined):

① TTET40 ② STD ③ 462





 = Kwik Office model available.
 ▶ See the Kwik Office Price List.

▶ See page

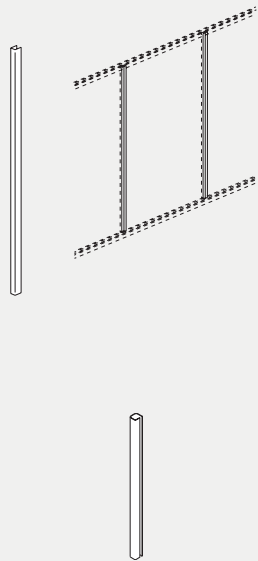
Finishes & Materials	527
Statement of Line	310

Trim Channels and Vertical Cable Managers



D	W	H	Model	Description	Price
Trim Channels					
<i>For Use with 37"H Xsite or Cetra Tiles</i>					
1/2"	3/4"	367/8"	TTTC37N	Fabric; one trim channel	\$48
			TTTC37P	Paint; one trim channel	42
<i>For Use with 36"H Interworks EQ Tiles</i>					
1/2"	3/4"	357/8"	TTTC36N 	Fabric; one trim channel	\$47
			TTTC36P 	Paint; one trim channel	40
<i>For Use with 49"H Conferencing Solutions Tiles</i>					
1/2"	3/4"	487/8"	TTTC49N	Fabric; one trim channel	\$55
			TTTC49P	Paint; one trim channel	52
Vertical Cable Manager					
<i>For Use with Standard-Height Square and Radius Profile Overheads and 37"H Tiles</i>					
1"	1"	183/4"	TTVCM19B	Black	\$29
			TTVCM19N	Fabric	40
<i>For Use with Curved, Lunar, Bevel, and Reduced-Height Square and Radius Profile Overheads and 37"H Tiles; For Use with Curved, Lunar, and Bevel Profile Overheads and 36"H Tiles</i>					
1"	1"	191/2"	TTVCM20B 	Black	\$29
			TTVCM20N 	Fabric	38

Specifying Tips:

- Trim channels are provided with all tiles. Specify only if additional trim channels are required.
- Vertical cable manager engages between the tile and trim channel.
- Railroaded fabric option is available on 37"H and 49"H trim channels or 37"H vertical cable managers for use with Xsite.

How to Specify:

Trim Channels

- ① Model
- ② Railroaded fabric option (applies to TTTC37N and TTTC49N only):
Y = Yes
N = No
- ③ If paint, finish price group:
STD = Group 1
STDM = Group M (+10%)
 If fabric, fabric grade
- ④ Finish designator or fabric number

Sample (base model underlined):

① ② ③ ④
TTTC37N Y B 2202

Vertical Cable Managers

- ① Model
- ② Railroaded fabric option (applies to TTVCM19N only):
Y = Yes **N** = No
- ③ Fabric grade (include for fabric models only)
- ④ Fabric number (include for fabric models only)

Sample (base model underlined):

① ② ③ ④
TTVCM19N Y B 2202

Brackets and Traxx Spacers

K = Kwik Office model available.
 ▶ See the Kwik Office Price List.

▶ See page

Finishes & Materials	527
Statement of Line	310

D	W	H	Model	Description	Price
Worksurface Brackets					
			IBTWS K	Single bracket	12
Overhead Brackets					
<i>For Use with Radius, Square, and Curved Profile Overhead Storage Units</i>					
			FBOTS	Single bracket. Specify two brackets for use with 24"W-48"W overheads; specify four brackets for use with 60"W-72"W overheads	\$14
<i>For Use with Bevel and Flat Profile Overhead Storage Units</i>					
1 1/8"	3 5/8"	16 5/8"	ISBRKT K	Set of 2; one set required per overhead	\$32
<i>For Use with Lunar Profile Overhead Storage Units</i>					
			24STXOHB	Set of 2; specify one set per 24"-48"W overhead	\$31
			24STXOHB3	Set of 3; specify one set per 60"-72"W overhead	49
Traxx Spacers					
<i>For use with Radius, Square, and Curved Profile Overhead Storage Units</i>					
5/8"	7 1 3/16"	1"	TTBS72	One 72"L section; black.	\$24
<i>For use with Bevel and Flat Profile Overhead Storage Units</i>					
1/2"	3 3/8"	14 1/8"	ISBRKTSO K	Set of 2; one set required per overhead.	\$63
<i>For use with Lunar Profile Overhead Storage Units</i>					
1/2"	3 3/8"	12"	24STXOHSO	Set of 2; one set required per overhead.	\$65

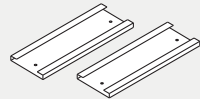
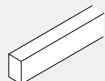
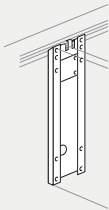
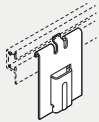
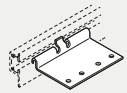

TTBS72

ISBRKTSO
24STXOHSO

Specifying Tips:

- Specify worksurfaces and overhead storage separately.
 ▶ See the Storage section for planning information.
- Specify Traxx spacer when Traxx mounting overheads without tiles.

How to Specify:

Worksurface Brackets

- ① Model

Overhead Brackets and Traxx Spacers for Use with Radius, Square, and Curved Profile Overheads

- ① Model

Overhead Brackets and Traxx Spacers for Use with Bevel, Flat, or Lunar Profile Overheads

- ① Model
- ② Finish price group:
STD = Group 1
STD M = Group M (+10%)
- ③ Finish designator

Sample (base model underlined):

① ② ③
ISBRKT STD 462