



Itsa™

Overview and Pricing

Kwik Office Models:



Itsa 1.0

- Knee tilt (**QK38AA**) or synchro tilt (**QK38BB**)
- Black mesh back
- Select Spectrum fabric on seat
- Seat slider optional
- 38½"-43"H x 27¾"W x 25½"D



Itsa 2.0

- Knee tilt (**QK38CC**) or synchro tilt (**QK38DD**)
- Black mesh back
- Select Spectrum fabric on seat
- Seat slider optional
- 38½"-43"H x 27½"W x 26½"D

Mesh back is 84% texturized polyester and 16% elastin. The mesh is pulled over a metal frame and closed at the bottom with a zipper.

Seat cushions feature a seamless, pull-over style upholstery. 1.0 models have 2½" of molded, CFC-free, urethane foam applied over a recycled plastic seat shell. 2.0 models (shown) have 1" slab foam with a ½" foam overlay topper and a ½" foam bottom (to give contour to seat) applied over a plywood seat shell.

Contoured "sit spot" and waterfall front edge provides optimal seated support and prevents undue pressure in the lower thigh/knee area.

5-prong base is constructed of extremely rigid, glass-filled nylon. Black surface is textured for scuff resistance.

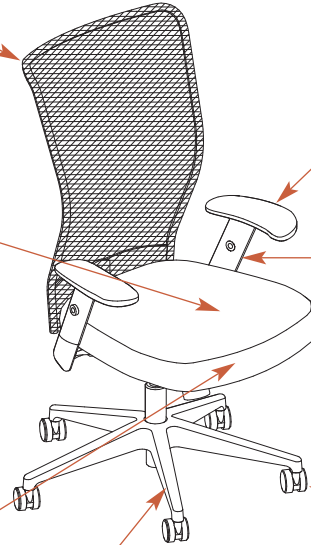

Arm caps are soft, self-skinning polyurethane foam molded over a steel core for strength.

Arms are height adjustable within a 2¼" range by the push of a button. 1.0 models lock into one of 7 positions. 2.0 models (shown) lock into one of 5 positions.

Black, hard dual-wheel casters are standard.

How to Specify:

- Model:
QK38AA = Itsa 1.0 with knee tilt
QK38BB = Itsa 1.0 with synchro tilt
QK38CC = Itsa 2.0 with knee tilt
QK38DD = Itsa 2.0 with synchro tilt

Seat:

- Upholstery grade:
2 = Price Grade 2
- Upholstery number:
20011 = Spectrum Sand
20020 = Spectrum Black
20022 = Spectrum Burgundy
20067 = Spectrum Navy
20081 = Spectrum Charcoal
- Seat slider:
SL = Seat slider (+\$100)
X = None

Sample (base model underlined):

① ② ③ ④
QK38AA 2 20200 SL

Pricing:

QK38AA or QK38CC
\$701

QK38BB or QK38DD
\$801