

Interworks® EQ

Stackable Panel

Tools Required

Level, Screwgun with #2 Magnetic Phillips Bit (2 1/2" minimum long), 3/8" Socket or Wrench

Installation

For stackable panels two people are recommended. Base panel top cap will be moved on top of assembled stackable panel. In track of base panel, insert set of mounting brackets, (note proper orientation of brackets). Connection bolts join base panel and stackable panel securely.

Step 1

Prep Support Panel

- Remove top cap from base panel.
- Remove panel hinges from stackable panel. (Detail A)
- Use screwdriver to spread apart top channel and insert mounting brackets into channel. Center tab on bracket against inside edge of cable slot on channel frame. Fasten brackets to channel frame with screwgun and self tapping screws.(Detail B)

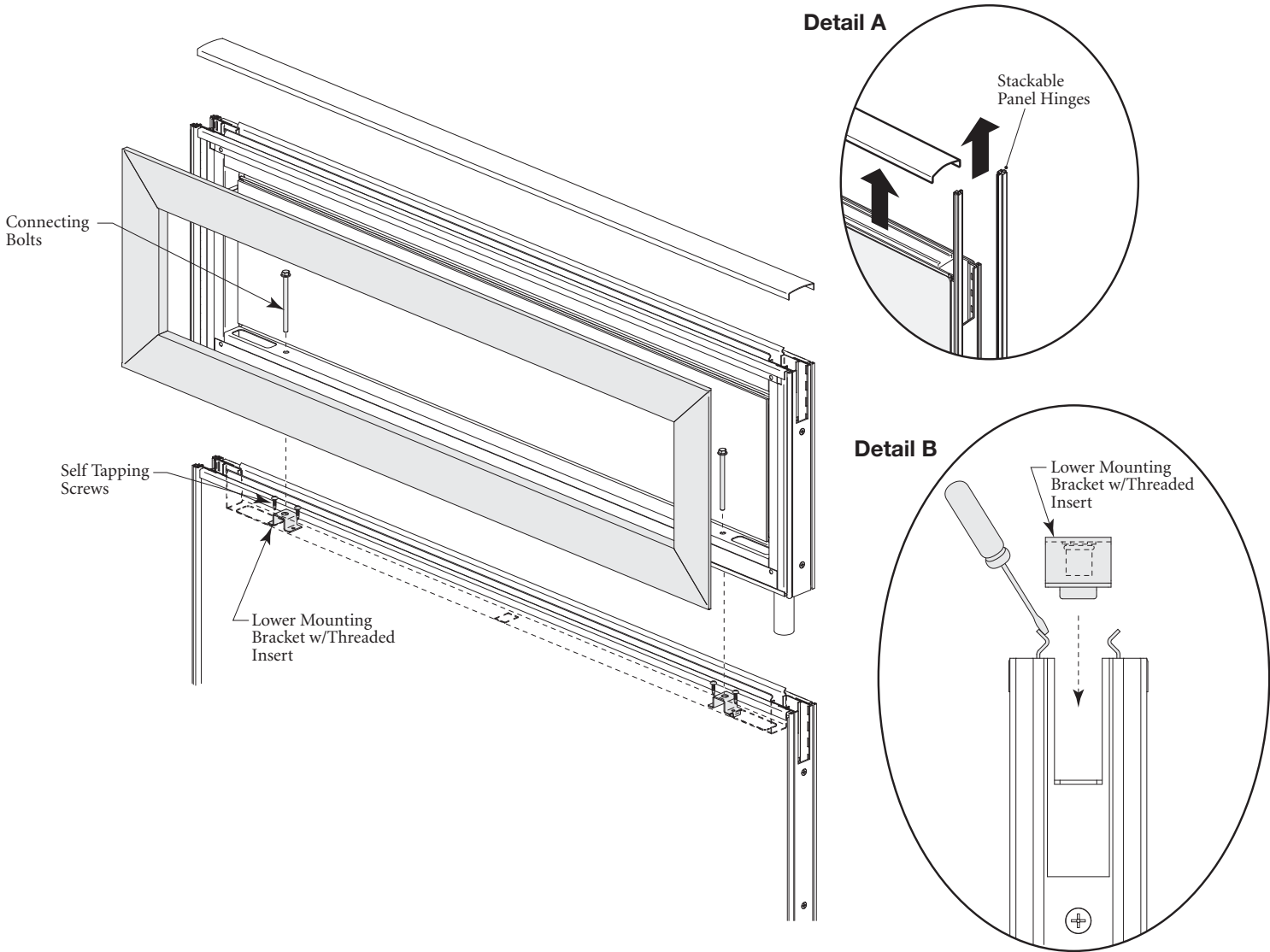

Proper product installation, in accordance with these instructions, is the responsibility of the installing agent. If you have any questions concerning these instructions, please call Kimball Office Customer Service.

Kimball Office

Stackable Panel, *continued*

Step 2

Prep Stackable Panel Assembly

- Remove tiles from stackable panel.
 - On fabric stackers, push tile up against top of J channel on stacker frame until bottom of tile clears lip of lower J channel. Tilt bottom of tile outward then pull down to remove it.
 - On glass stackers, remove the non-glass frame half as described above. Remove the glass frame half by first removing the screws from the retaining clips which secure the glass frame to the stacker frame. Remove the retaining clips, and then remove the glass frame half as described above.

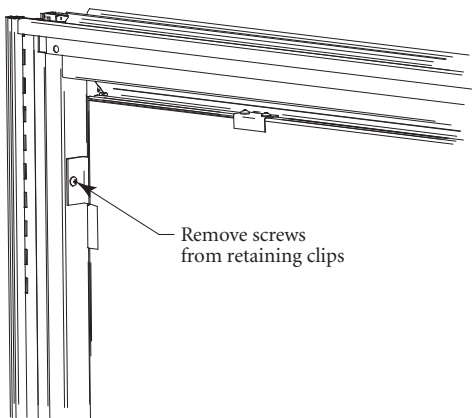

Step 3

Install Stackable Panel Assembly

- Lower stacker assembly onto the base panel. The round tubes from the stacker panel go into the vertical tubes of the base frame. Lower both sides of the stacker panel simultaneously to prevent binding.
- Insert connection bolt through holes in bottom cross-member of stackable panel, and fasten into lower mounting bracket installed previously in Step 1.
- Tighten connection bolt. Do not overtighten. Stop when bottom cross-member begins to deform.

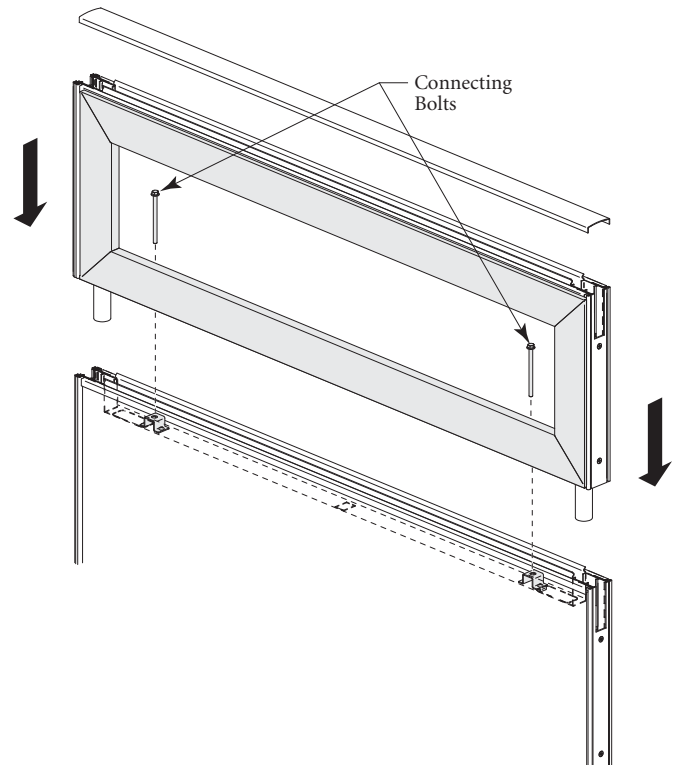

Stackable Panel, *continued*

Step 4

Reinstall Hinges

Note: If stackable panel will be loaded on one side, go to Step 5.

- After stackable panels are installed on base panel install panel hinges between stackable panels.
- Replace panel top caps.

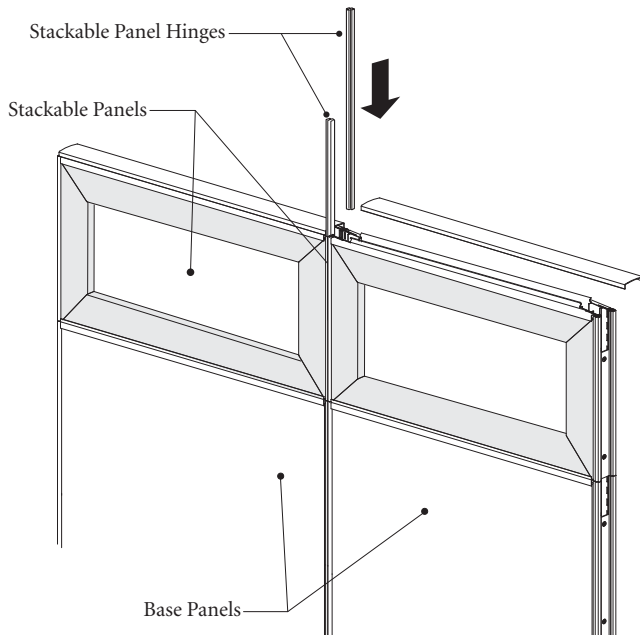

Step 5

Stiffener Bracket

- Cut 10" from base panel hinges (cut must be straight and level).
- Install shortened hinges into base panels.
- Install stiffener bracket into stackable panels and base panels.
- Replace panel top caps.

