

Interworks® EQ

Panels – Finish Channels

Tools Required

Flathead Screwdriver, Rubber Mallet (non-marring)

Installation

These instructions apply to installation of finish channels and top caps in the configurations shown. Finish channels are required at exposed junctions. It is easiest to install finish channels as adjacent panels are assembled. Top caps and base covers can be installed last.

Vocabulary

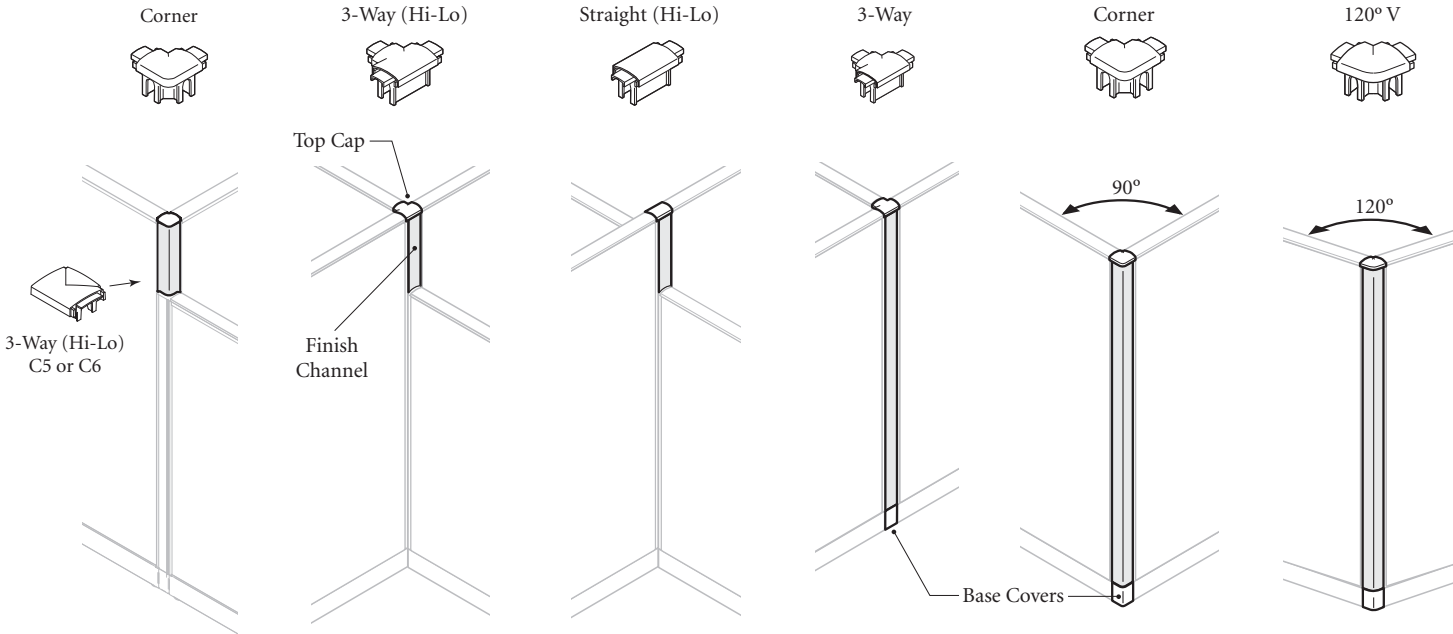

Panel Connections and Alignment Clip Usage

Note: Alignment clips are required for panel stability. Alignment clips fit into alignment brackets near the base of the panel.

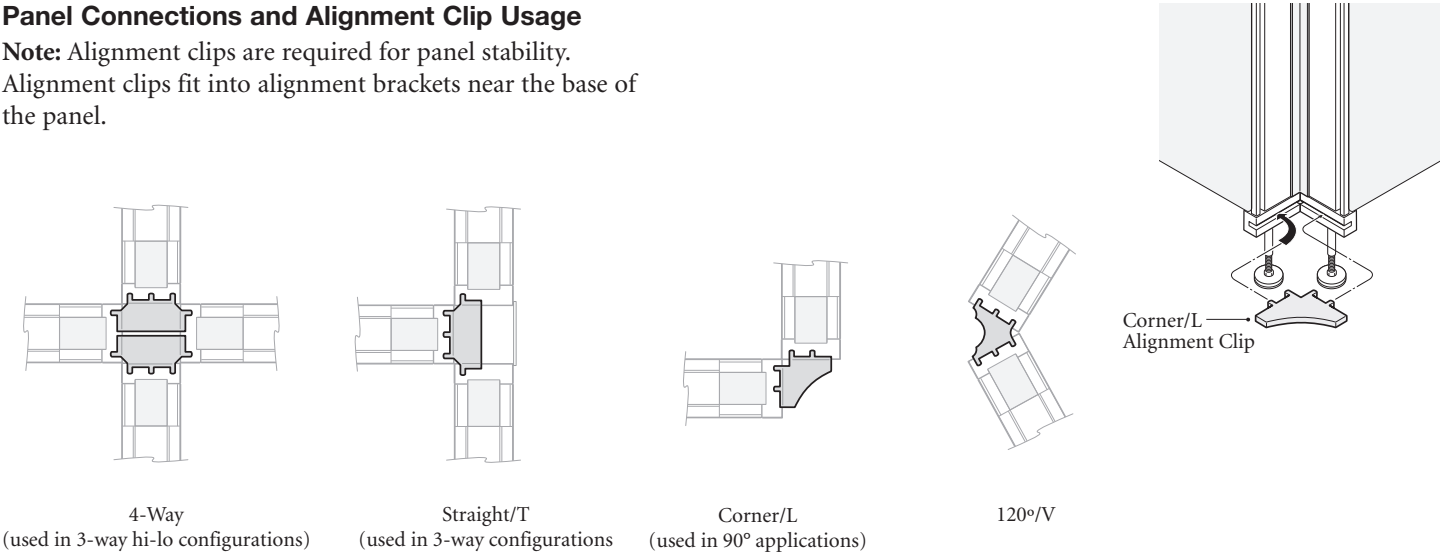

Proper product installation, in accordance with these instructions, is the responsibility of the installing agent. If you have any questions concerning these instructions, please call Kimball Office Customer Service.

Kimball Office

Interworks® EQ

Panels – Finish Channels, *continued*

Step 1

Top-Down Method

(if enough overhead room)

- Slide finish channel into side rail grooves
- Push down to alignment brackets/clip at the top of the wireway

Note: Flex do NOT bend channel

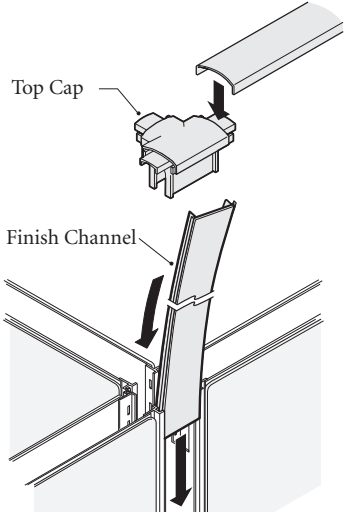

Snap-in Method—Corner or 120° Connections Only

(if not enough overhead room)

- Pivot panel inward to narrow the junction opening
- Push into side rail grooves
- Bend and push into opposite side rail
- Push panels back to snap in finish channel

Note: Do NOT bend channel horizontally

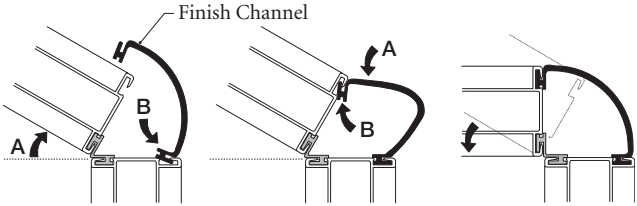

Step 2

Base Covers

- Insert one end of base cover into wireway cover
- Pull opposite wireway cover outward
- Push base cover in
- Tap wireway cover into base cover slot

Finishing

- Install finish channel top caps
- Replace necessary panel top caps and wire covers

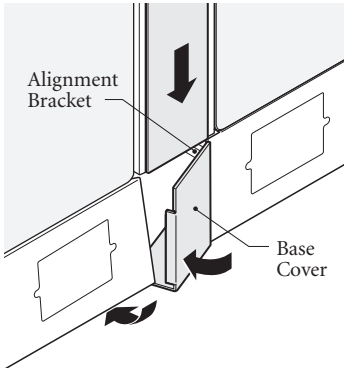

Proper product installation, in accordance with these instructions, is the responsibility of the installing agent. If you have any questions concerning these instructions, please call Kimball Office Customer Service.

Kimball®Office