Approach[™] Assembly Instructions

2066781 Revision A-10
Complete Series Master Packet

Proper product installation, in accordance with these instructions, is the responsibility of the installing agent.
If you have any questions concerning these instructions, please call Kimball Office Customer Service.

© 2008 Kimball International, Inc. T 800.482.1818 F 812.482.8300

Approach™

Back Attachment

Installation

1. Take components out of box. (Figure A).
2. If chair has plastic back, remove knob by turning counter clockwise. If chair comes with mesh back, simply pull knob directly off, no unscrewing is required. (Figure B).
3. On models with plastic backs, align bottom of back over metal bracket. Insert metal bracket into slot in bottom of back and slide back downward. (Figure C).

Figure A

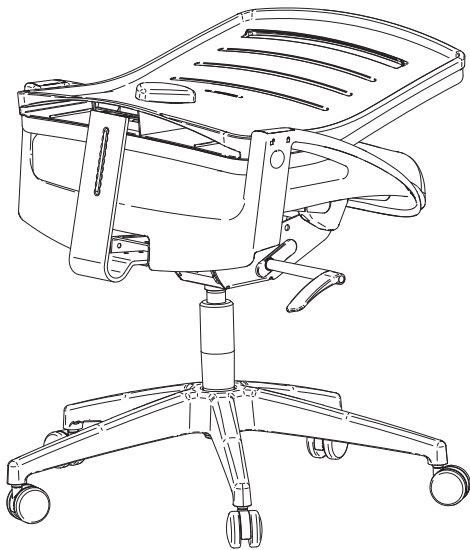

Figure B

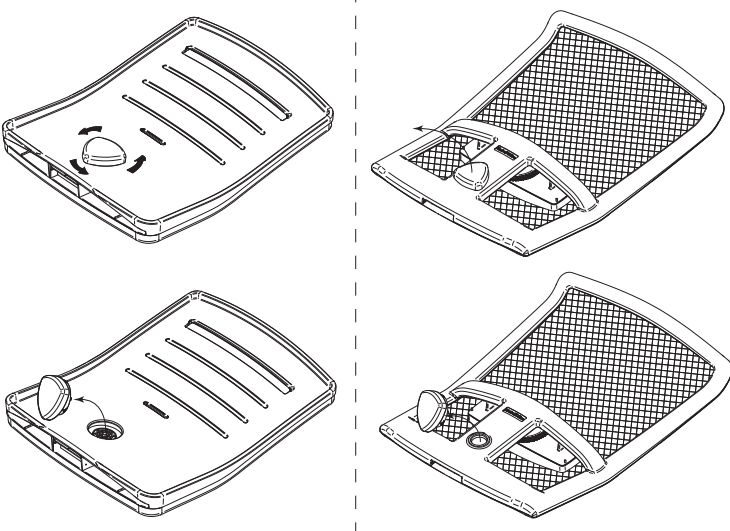
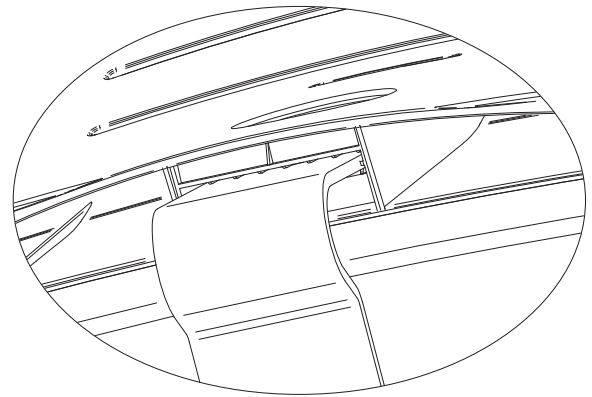
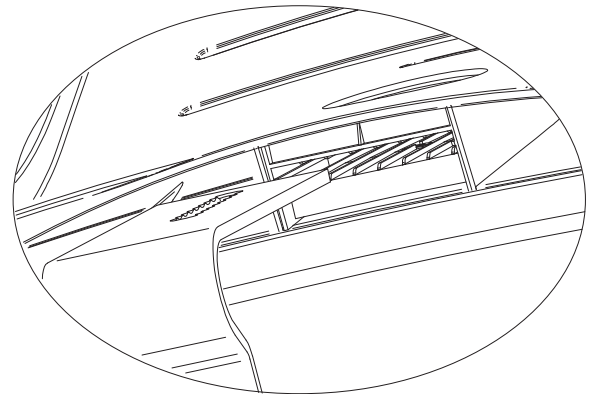
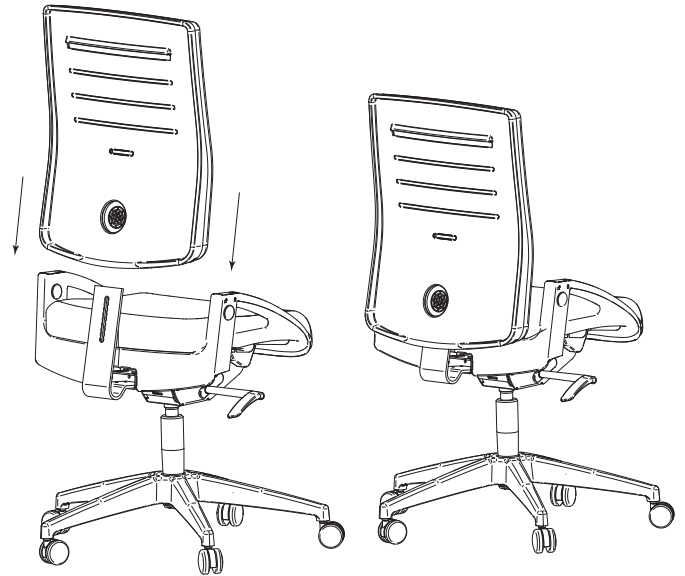

Figure C



Proper product installation, in accordance with these instructions, is the responsibility of the installing agent. If you have any questions concerning these instructions, please call Kimball Office Customer Service.

Kimball® Office

Approach™

Installation (continued)

4. On models with mesh back, align bottom of back over bracket. Insert metal bracket into slot in bottom of back and slide back downward. Remove plastic plug out of knob insert. (Figure D).
5. On mesh back, screw back knob into back by pushing and turning at the same time. On plastic back you do not need to push on knob. (Figure E).
6. If back height needs adjusted, loosen back knob slightly so the plastic back will slide vertically. Adjust into desired position, and retighten knob. (Figure F).

Figure D

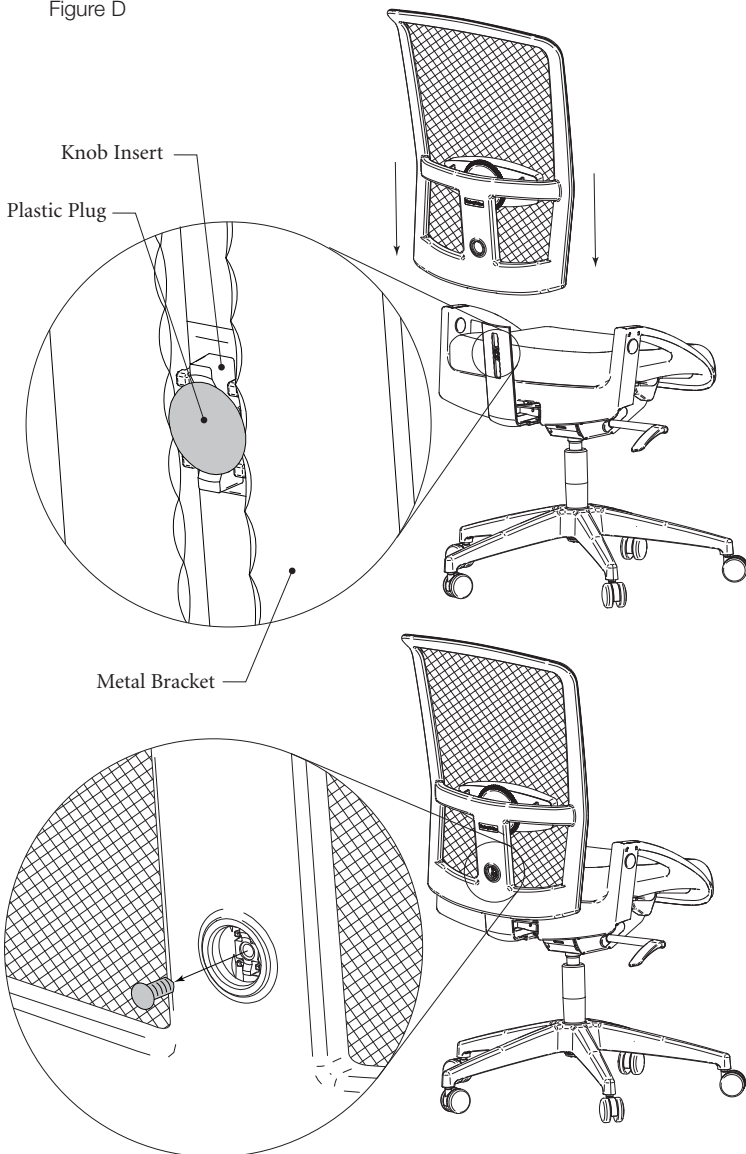

Figure E

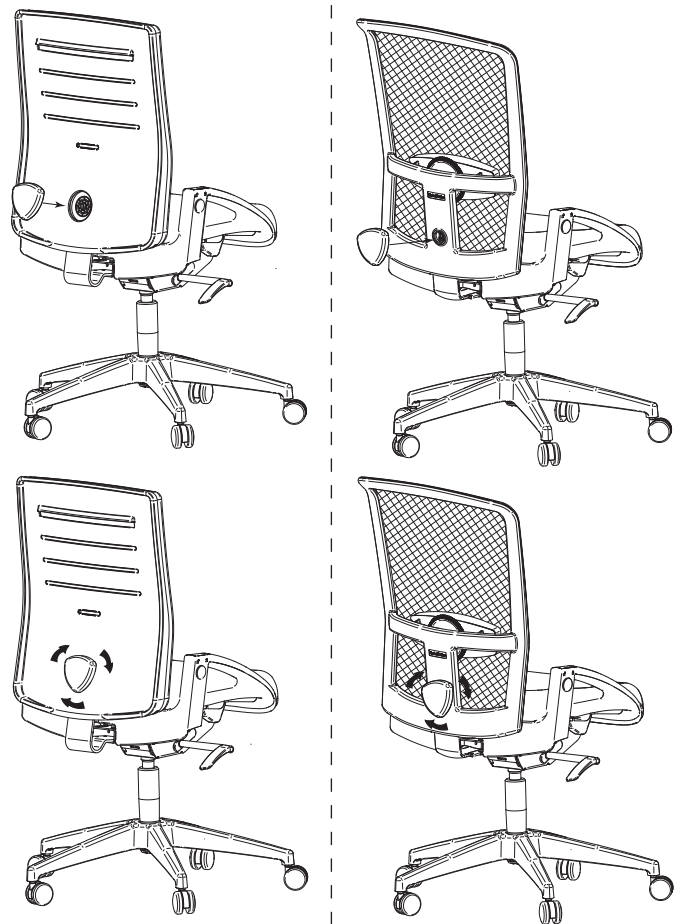
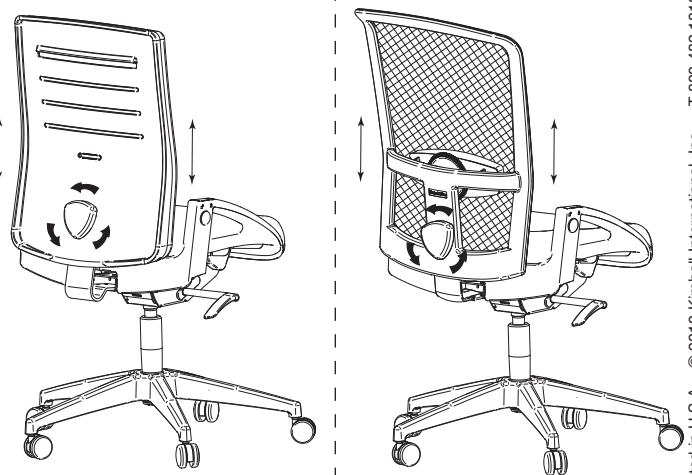

Figure F



Printed in U.S.A. © 2010 Kimball International, Inc. T 800.482.1818 F 812.482.8300

Proper product installation, in accordance with these instructions, is the responsibility of the installing agent. If you have any questions concerning these instructions, please call Kimball Office Customer Service.

Kimball®Office

Approach™

Seat & Back Removal/Insert Assembly

Installation

1. While lifting front edge of seat pad, with palm of hand gently hit front right and front left of seat pad to release seat clips.
Note: Seat slider model must be placed all the way back before removing. (Figure A).
2. Remove seat pad from seat. (Figure B).
3. Gently slide new seat pad from front to back of seat until it drops into place. (Figure C).
4. Using palm of hand, press firmly on each of the four corners of the seat to engage clips. (Figure D).

Figure A

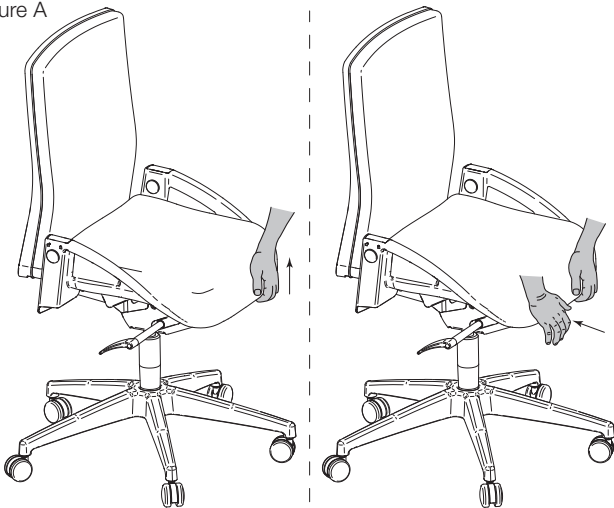

Figure B

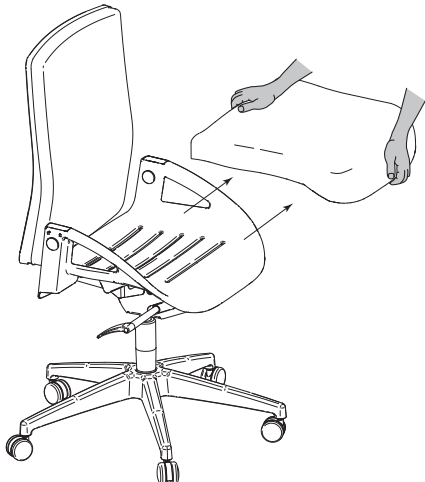

Figure C

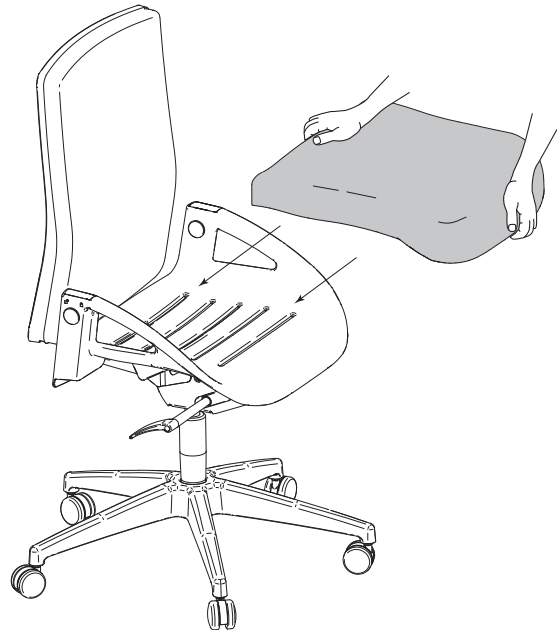
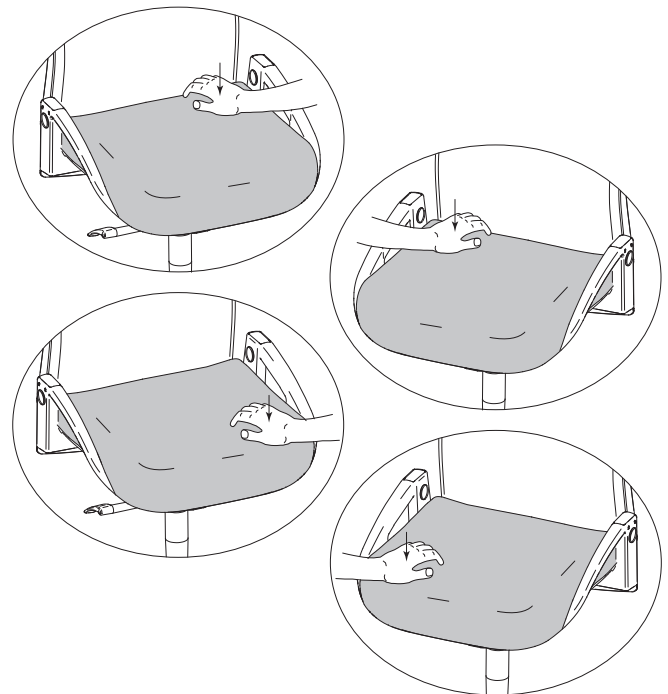

Figure D



Proper product installation, in accordance with these instructions, is the responsibility of the installing agent. If you have any questions concerning these instructions, please call Kimball Office Customer Service.

Kimball Office

Approach™

Installation (continued)

5. Remove Upholstered Seat Pad. (Refer to Step 1 & 2).
6. Un-hook two clips at bottom of back. (Figure E).
7. Slide Back pad up and pull off of front of back. (Figure F).
8. Align new back pad with slot at top of back, insert in and slide down. (Figure G & H).
9. Snap hooks at bottom of pad to back. (Figure I.).

Figure E

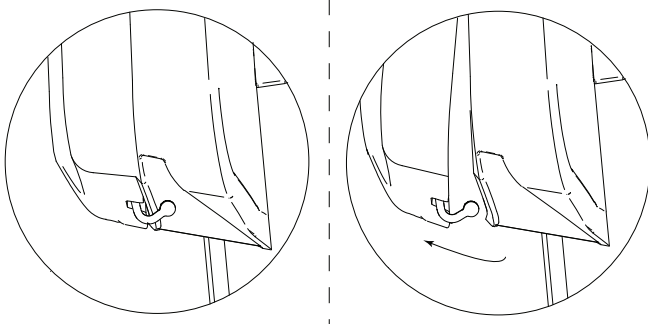

Figure F

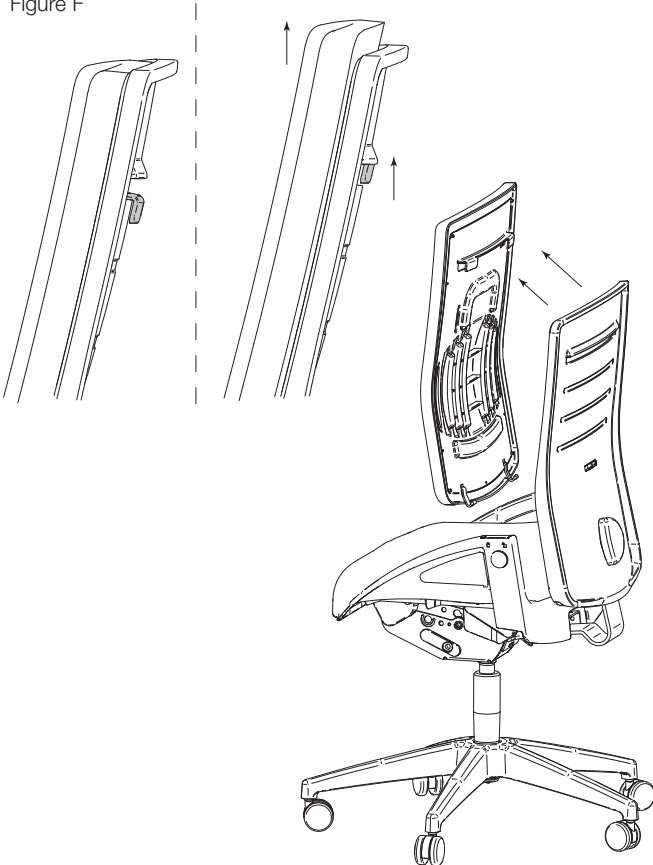

Figure G

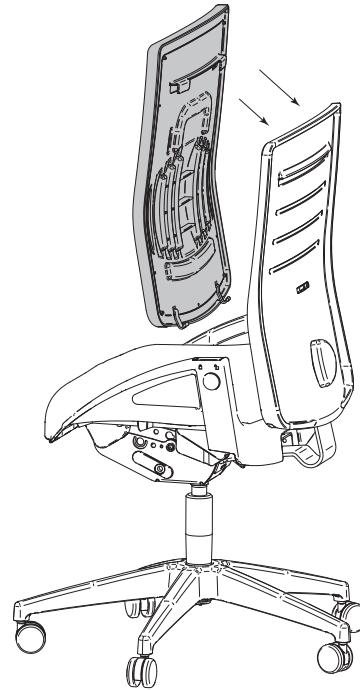

Figure H

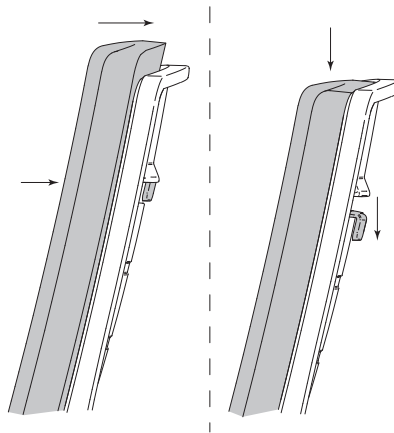

Figure I

