

# Cetra<sup>®</sup> Footprint<sup>®</sup>

Assembly Instructions

## Wood Support Cylinder

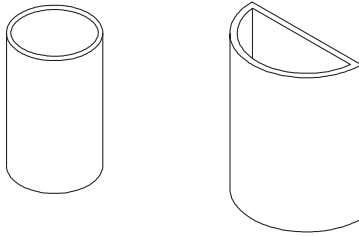

**Figure A**

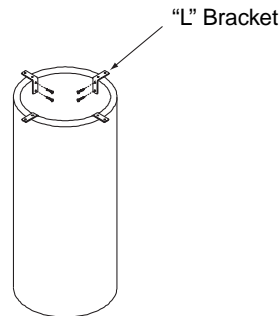

**1**

Attach the four “L” brackets to the inside of the support base with the eight screws provided (Figure A).

**2**

Place worksurface on clean, solid surface, back side facing up. Mark the center of the worksurface where the support base attaches (Figure B).

**Figure B**

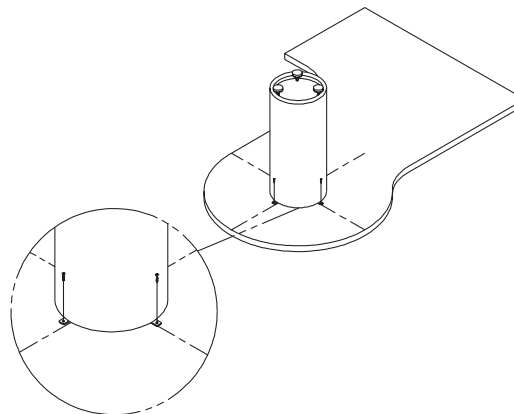

**3**

Attach the support base to worksurface using screws provided (Figure B).

**4**

Place worksurface and attached support base onto worksurface brackets. Attach worksurface to worksurface brackets and flat brackets. Reference Assembly Instruction Sheet #AISYCE014C-01 and #AISYFP004.

**Figure C**

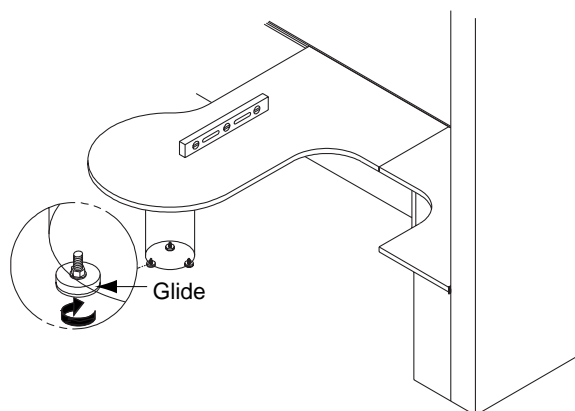

**5**

Level worksurface by turning the glides, on the bottom of the support base, by hand or 1/2" open end wrench (Figure C).

### Recommended Tools

- Tape Measure
- Variable Speed Drill with Torque Option
- #2 Phillips Bit
- Level
- 1/2" Open End Wrench

### Package Contents

	Qty.
• Support Base	1
• “L” Bracket	4
• #8 x 5/8" Screw	8



Telephone 800.482.1818  
Fax 812.482.8300  
www.furniture.kimball.com

Form #AISYCE029B-01  
#1237537

Printed in U.S.A.  
© 2001 Kimball International, Inc.