

# Footprint®

## Hinged Door Field Installed Lock Kit

### Tools Required

- Tape Measure
- 1/16" Dia. Drill Bit
- Center Punch
- 1/8" Dia. Drill Bit
- 2 1/32" Guide-point Wood-boring Drill Bit
- Electric Drill
- #2 Phillips Bit

### Package Contents

- Lock Assembly
- #6 x 1/2" Screws
- Lock Catch "U"
- #8 x 5/8" Screws

### Installation

**Note:** Lock is installed on right hand swinging door.

1. Using dimensions from Figure A, mark the lock hole location with a center punch on the back of the door. Bore a 1/8" diameter pilot hole through the door. Bore a 1/8" diameter pilot hole through the door. (Figure A).
2. Using the 2 1/32" guide-point wood-boring drill bit, bore approximately halfway through the door. Complete boring the hole from the opposite side of the door.
3. Insert lock assembly into 2 1/32" (17mm) diameter hole as shown in Figure B. Bore two pilot holes 1/16" diameter by 1/2" deep. Using the flathead screws provided, attach lock assembly to door. (Figure B).
4. Using dimensions from Figure C, mark the lock catch location with a center punch on the back of the left door. Bore two pilot holes 1/16" diameter by 1/2" deep. (Figure C). Attach the lock catch using the panhead screws provided. (Figure D).

Figure A

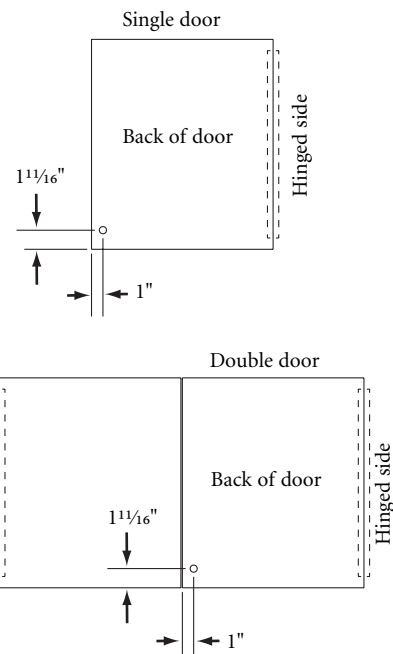

Figure B

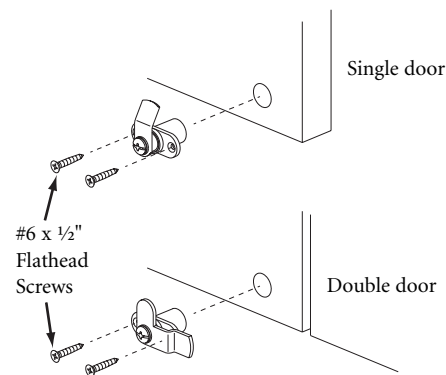

Figure C

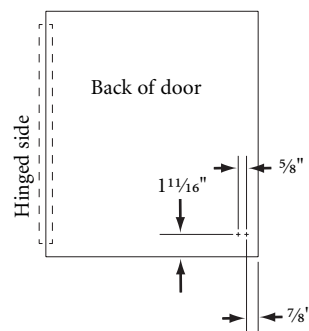
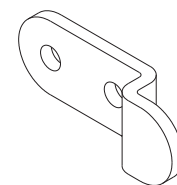

Figure D



# Footprint

## Installation (continued)

- Using dimensions shown, mark the lock catch location with a center punch. Bore two pilot holes  $\frac{1}{16}$ " diameter x  $\frac{1}{2}$ " deep. (Figure E).

Nominal Cabinet Width	Dim. A	Dim. B
24"	$9\frac{9}{16}$ "	—
30"	$12\frac{9}{16}$ "	—
36"	$15\frac{9}{16}$ "	—
42"	$11\frac{5}{8}$ "	$12\frac{11}{16}$ "
48"	$13\frac{5}{8}$ "	$14\frac{11}{16}$ "
60"	$12\frac{9}{16}$ "	$28\frac{11}{16}$ "
72"	$15\frac{9}{16}$ "	$40\frac{11}{16}$ "

- Using the panhead screws provided, attach the lock catch. (Figure F).

Figure E

24", 30", 36" Wide Cabinet:

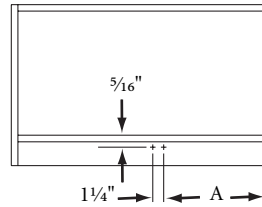

42", 48" Wide Cabinet:

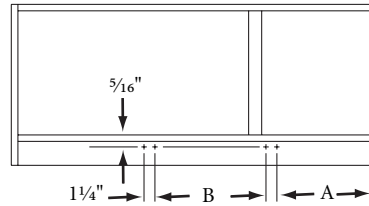

60", 72" Wide Cabinet:

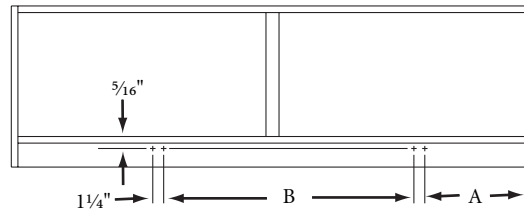

Figure F

