

Footprint®

Wall Standards

Tools Required

- Tape Measure
- Level
- Tools to install fasteners
- Shim, if using Wall Standards as listed along with TRAXX® Wall Mount, or if wall surface is uneven

General Information

- These instructions provide the basic information to install wall standards.
- Maximum two components per pair; maximum storage load per component not to exceed 150 pounds.
- Not designed for use with worksurfaces.
- One person can perform all operations.

Recommended Fasteners

Kimball does not assume responsibility for improper fastener selection or installation. Consult a reliable installer.

- Dry Wall** Must be at least 5/8" thick. Use 3/16" hollow wall fasteners or 3/16" toggle bolts with countersunk flat head machine screws.
- Wood Studs** Must be nominal 2" x 4" size, on no more than 24" center with maximum height of 14 feet restrained at floor and ceiling. Use #10x2" countersunk flat head screws.
- Metal Studs** Must be "C" channel, 20 gauge, on no more than 24" center. Maximum height of 14 feet restrained at floor and ceiling. Use 3/16" hollow wall fasteners or 3/16" toggle bolts with countersunk flat head machine screws.
- Concrete** Use concrete wall anchors with #10x1 1/2" countersunk flat head machine screws.

Fasteners required:

10 per 62"H and 66"H units; 12 per 80"H units

Setup

- Wall standards contain side rail slots to coincide with those on the panel, allowing components to be mounted and adjusted at 1" increments. (Figure A).
- Vertical position of wall standards is determined by relation to any adjacent panels. Horizontal position is determined by the width of the component being mounted to wall standard.
- Adjacent panels, including wall-mounted or Traxx-mounted panels, must first be installed and properly leveled.

Figure A

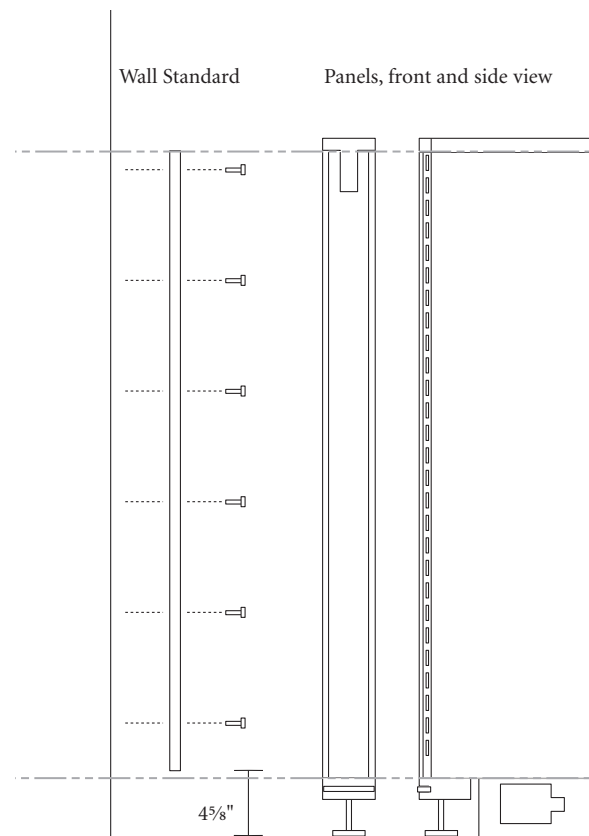

Footprint®

Installation (continued)

Vertical Positioning

1. To determine top of wall standard, note hole pattern. For top, hole is approximately 1½" from end of wall standard; for bottom, hole is 4" from end. (Figure B).
2. Begin with wall standards next to panels. Measure from the finished floor to the height of the lowest panel side rail slot.
3. Position wall standard on wall so lowest slot corresponds to lowest slot in the panel side rail. The bottom of the wall standard will be approximately 4⅝" above finished floor, providing the floor is level. (Figure B).
4. Mark hole locations through wall standard and plumb for square. Secure wall standard to wall.

Horizontal Positioning

- Horizontal position is determined by the width of the component being mounted to wall standard. (Figure C).
1. Position the second wall standard in the desired location and align with first wall standard.
 2. Install next pair of wall standards following the same steps as above. When locating two wall standards in a corner, position wall standards away from corner at least ¾".
Note: Components may not be located at the same height.
 3. Once wall standards are installed, hang components following appropriate installation guidelines outlined per component. (Figure D).

Figure C

Nominal Width	Edge To Edge	Determining horizontal location of wall standards based on component width
24"	23 53/64"	
30"	29 53/64"	
36"	35 53/64"	
42"	41 53/64"	
48"	47 53/64"	
60"	59 53/64"	

Figure B

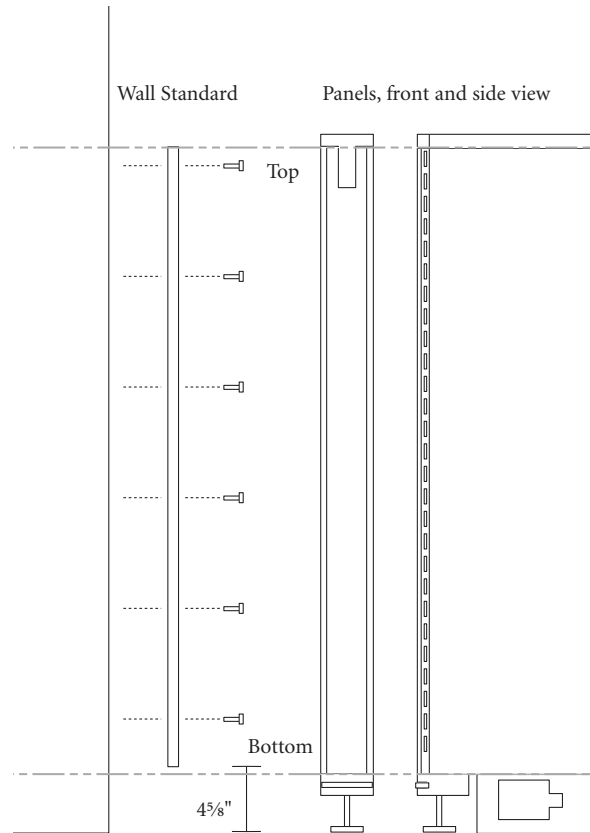
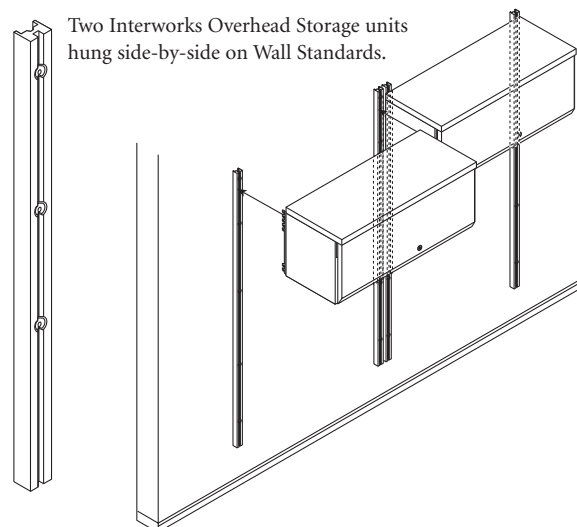

Figure D



Proper product installation, in accordance with these instructions, is the responsibility of the installing agent. If you have any questions concerning these instructions, please call Kimball Office Customer Service.

Kimball®Office