

Footprint®

Bevel Profile Highback Organizer

Tools Required

- Drill
- #2 Phillips head bit
- Level
- Tape Measure

Package Contents

- Overhead storage unit
- Two end panels (non-handed)
- Tackboard envelope
- Four #8 x 3/4" Phillips pan head drill screws
- 18 #10 x 1/2" hex washer head drill screws

Shipped Separately

- Tackboard
- Lock(s)

Description

These instructions provide basic information to assemble a Footprint bevel profile highback organizer and attach it to a Footprint freestanding modular worksurface with metal support or storage. Highback organizer must be the same width as the rectangular freestanding unit. Highback organizer is shipped ready to assemble (Figure A).

Note: One person can perform all operations, although two may be required to handle larger, heavier units.

Installation

1. Close and lock receding doors in overhead storage unit to prevent them from sliding open during installation.
Note: Locks are shipped separately from the unit. It is recommended that you install the lock prior to installation.
2. Turn overhead storage unit upside down with the door facing you.
3. Remove inset pieces from end support panels. With the smooth side of the left end support panels facing outward, secure the panel to the underside of the storage unit using three #10 x 1/2" screws in pre-drilled hold locations. Repeat for the right end support panel (Figure B).

Figure A

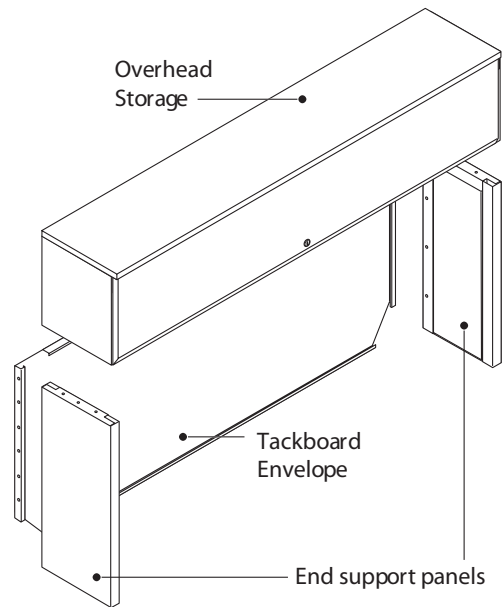
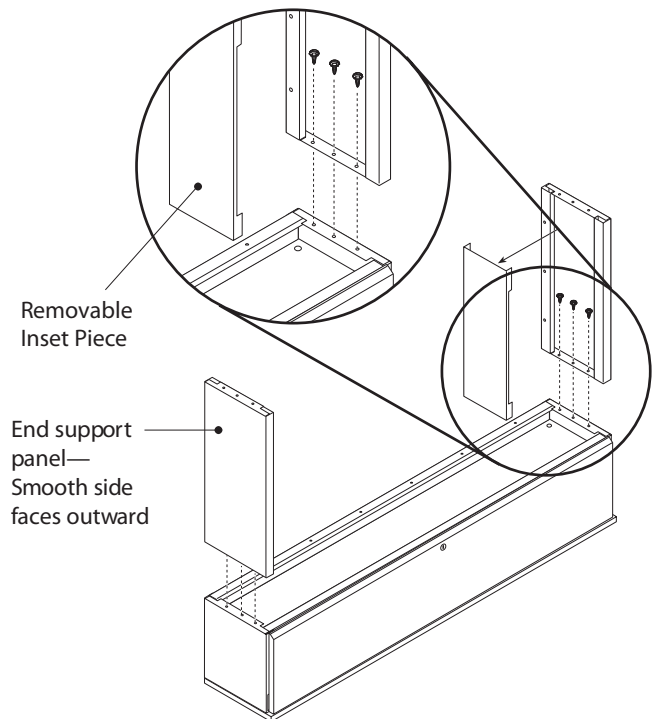

Figure B



Footprint®

Bevel Profile Highback Organizer, continued

4. With finished, smooth side of the tackboard envelope facing outward, and 45° cutouts facing upward, slide tackboard envelope down and in between the installed end support panels. Secure tackboard envelope to storage unit and end panels using #10 x 1/2" screws (Figure C).
5. Ensure that the freestanding unit is properly assembled and level.
6. Turn assembled highback organizer right side up. Place on top of freestanding unit, flush to the rear edge of the unit. Outside edge of each end support panel should be about 1/8" inset from the edge of the worksurface (Figure D).
7. Secure the highback organizer to the worksurface of freestanding unit using two #8 x 3/4" screws per end support panel (Figure D).
8. Replace inset pieces on both end support panels.

Figure C

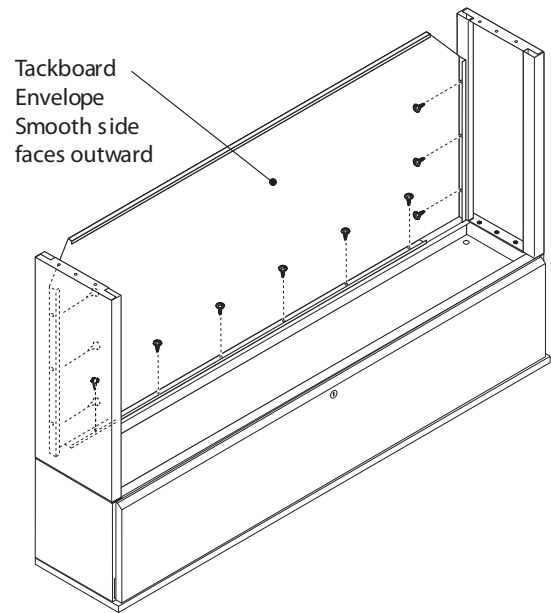
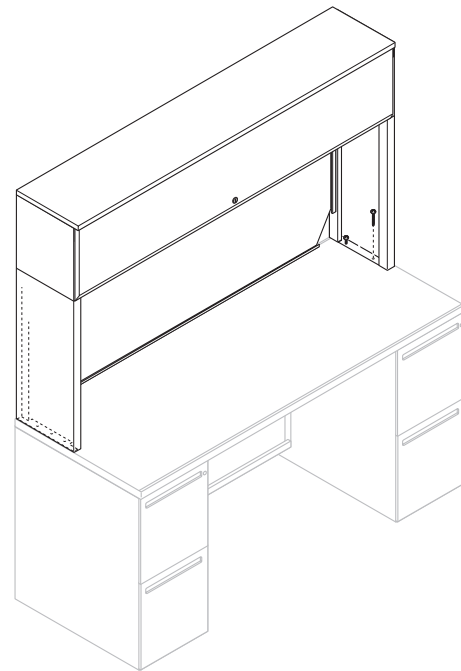

Figure D



Bevel Profile Highback Organizer, *continued*

9. With 45° cutouts pointing downward, slide the top of the tackboard up and into the tackboard envelope (Figure E).
Note: Highback organizer must be properly assembled, installed onto the worksurface, and level before installing the tackboard.

Figure E

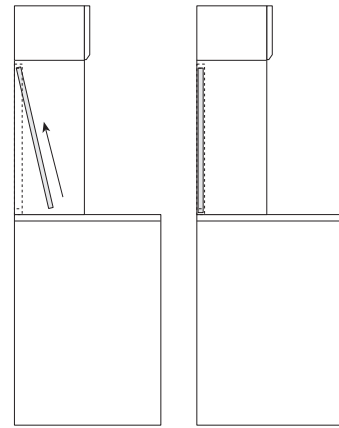

Figure F—Assembled and Installed Unit

