

# Footprint®

## Worksurface Cantilever Bracket for Interworks® EQ Panel

### Tools Required

- Drill with Torque Option
- Tape Measure
- #R-2 Square Srewdriver Bit
- Level
- Rubber Mallet

### Package Contents

- #8 x .75 Robinson Head Flakeboard Screw

### General Information

- Cantilevers are required when placing two surfaces end to end, when open kneespaces are greater than 48" for 1 3/16" surfaces or 60" for 1 9/16" surfaces, or in configurations where standard panel worksurface bracket support is not possible. Cantilevers are designed so that a single bracket can share the load between two adjacent surfaces. They can be used as sole support for a worksurface. The top of the cantilever should be located 24" from the bottom of fabric for standard height (29" nominal). (Figure A).

### Installation

1. Insert hook on the top of cantilever into the slot on panel siderail at a 45° angle. (Figure B).
2. Push the top of the cantilever downward. (Figure C).

**Important:** Use mallet to make sure bracket is seated and fully engaged.

Figure A

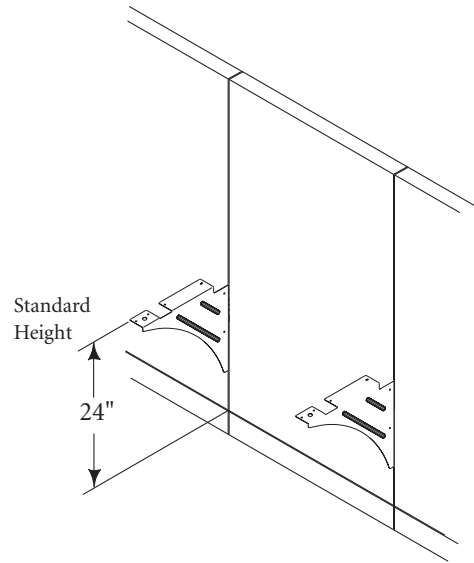

Figure B

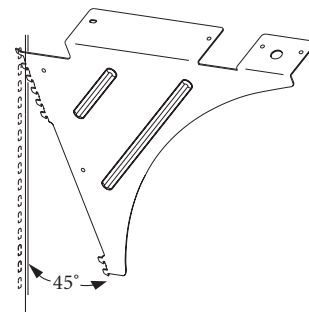
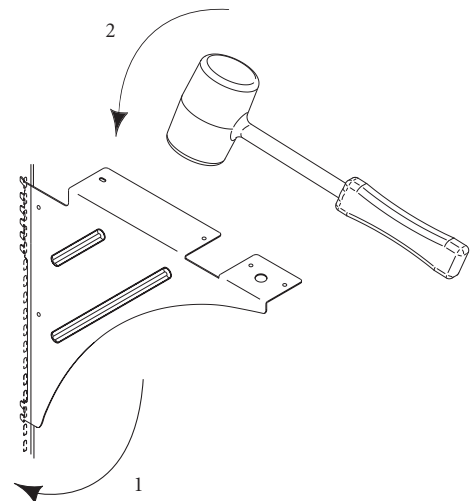

Figure C



### Installation (continued)

*Note: Cantilevers (with cutout to inside) are required with corner surfaces. (Figure D) With use of split top corner surface, corner cantilevers (with cutout to outside) must be located under adjacent surfaces. (Figure E). Cantilevers can be used as required support when open kneespace is greater than 48" for 1 3/16" surfaces and 60" for 1 9/16" surfaces. (Figure F).*

3. Attach worksurfaces with flat brackets and adjust alignment, if applicable.
4. Attach cantilever to worksurface with screws provided.

Figure D

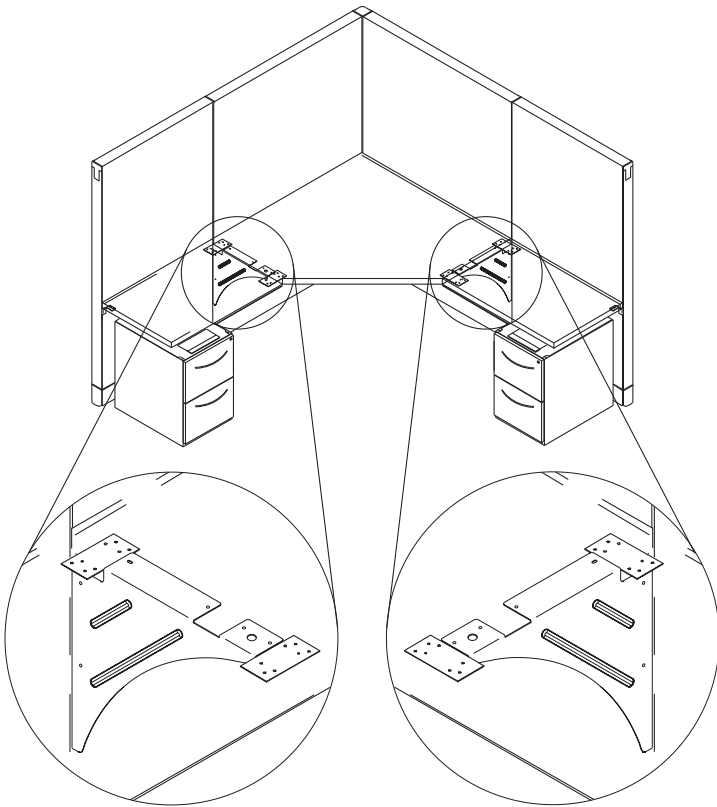

Figure E

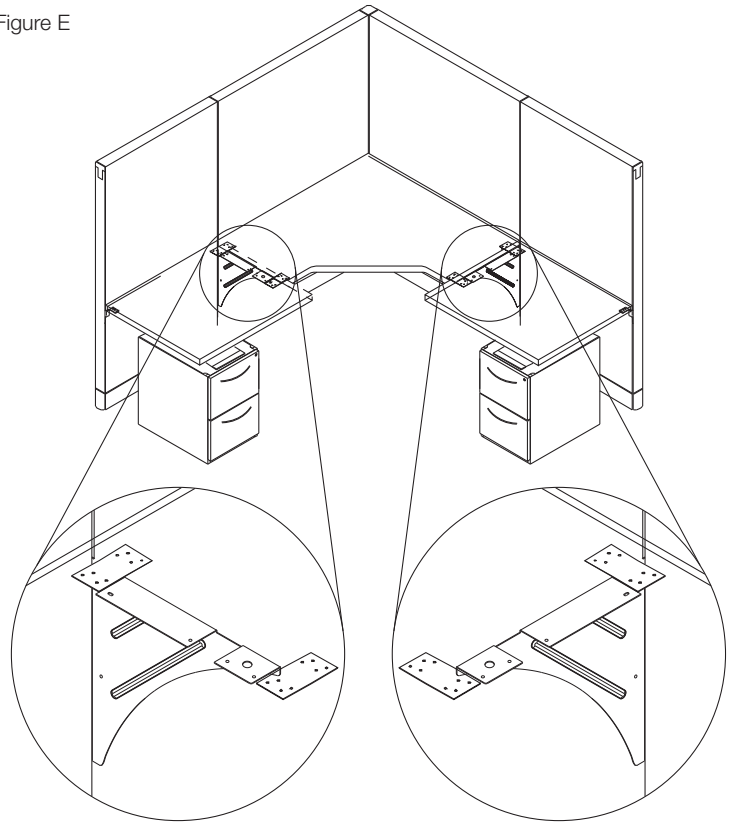

Figure F

