

Field Install Spacer Block for End Trim

Tools Required

- Tape Measure
- Rubber Mallet
- 7/16" Socket
- Cordless Drill
- #1 Phillips Screwdriver Bit

Note: The spacer blocks are designed to provide consistent reveal's on the end trim from one side to the other.

Installation

1. Remove end trim panel. (Figure A).
2. If present, remove existing spacer blocks from the back side of the end trim by knocking off with mallet. (Figure B).
3. Measure down approximately 1 1/4" from the top edge of the end trim and make a mark on each side of the "J" member. Measure up approximately 5" from the bottom and make a mark on each side of the "J" member. (Figure C).
4. Locate the top blocks vertically at marks, align top edge to mark. Align block horizontally with edge of the route/groove for the "J" member and install one #4 x 5/8" screw through each block. No pre-drilling is required. (Figure D). Locate the bottom blocks vertically at marks, align bottom edge to mark. Align block horizontally with edge of the groove for the "J" member and install screw. (Figure E).

Figure A

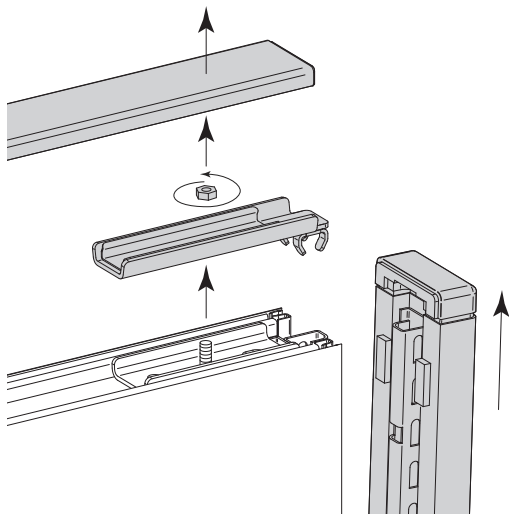

Figure B

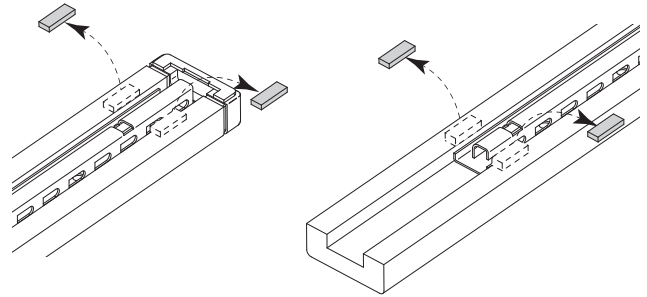

Figure C

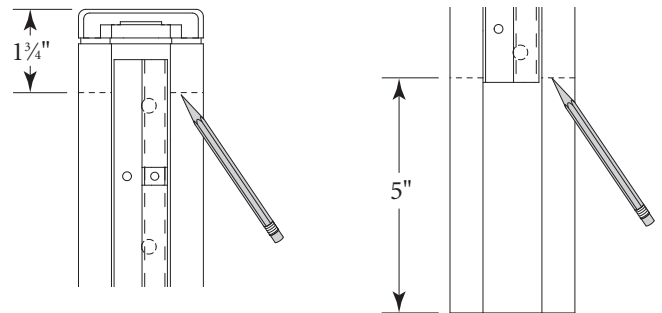

Figure D

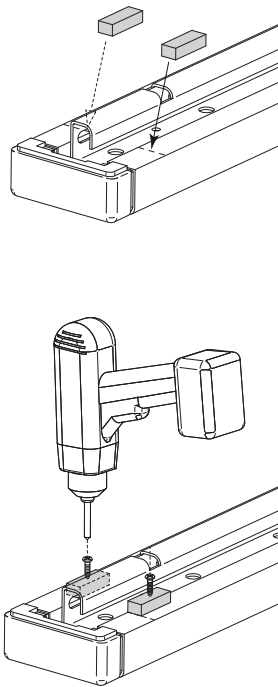
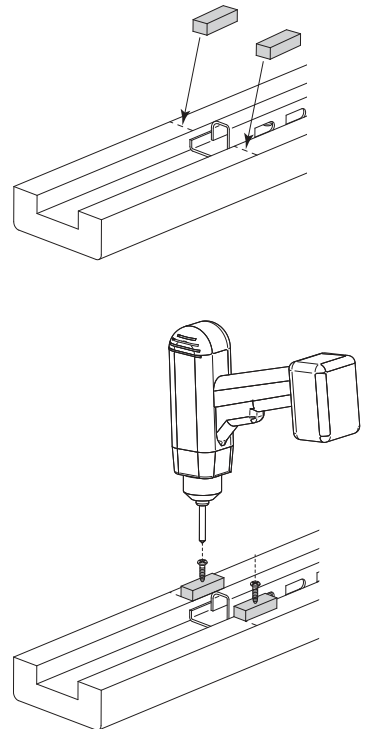

Figure E



Proper product installation, in accordance with these instructions, is the responsibility of the installing agent. If you have any questions concerning these instructions, please call Kimball Office Customer Service.

Kimball®Office

Cetra

Installation (continued)

5. To reinstall end trim, check to make sure the bottom end bracket is fully extended away from the panel to allow the “J” member to drop. If not, loosen the existing ¼" x 20 nut on the bottom panel end bracket and pull the bracket away from the panel and reinstall ¼" x 20 nut. (Figure F).
6. Slide the end trim down until seated. The end trim may not fully seat due to the tighter fit of the new spacer block. (Figure G).
7. Install NAAB clamp from the top end bracket into the top of the “J” member of the end trim. The top end bracket may not fully seat due to the tighter fit of the new spacer blocks. If not, tap on the top end bracket with a rubber mallet until the bracket and end trim is fully seated. (Figure H). Do not strike the wood end trim, as it may crack.
8. Secure the end trim by reinstalling the top end bracket with the ¼" x 20 nut. Align top cap and push down into place. (Figure I).

Figure F

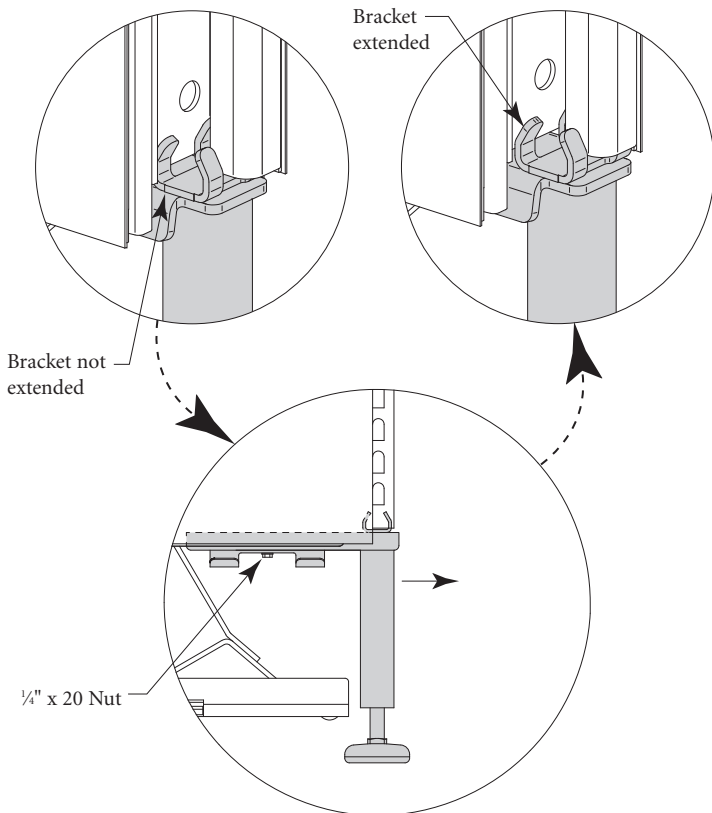

Figure G

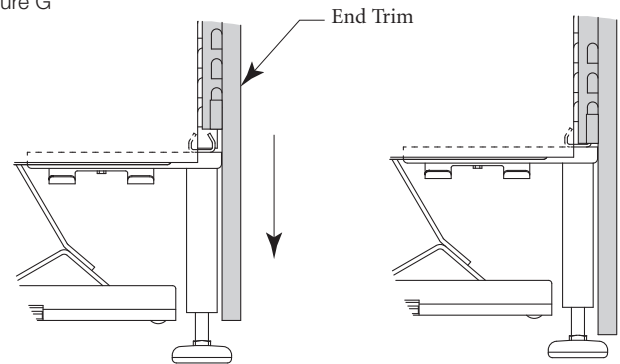

Figure H

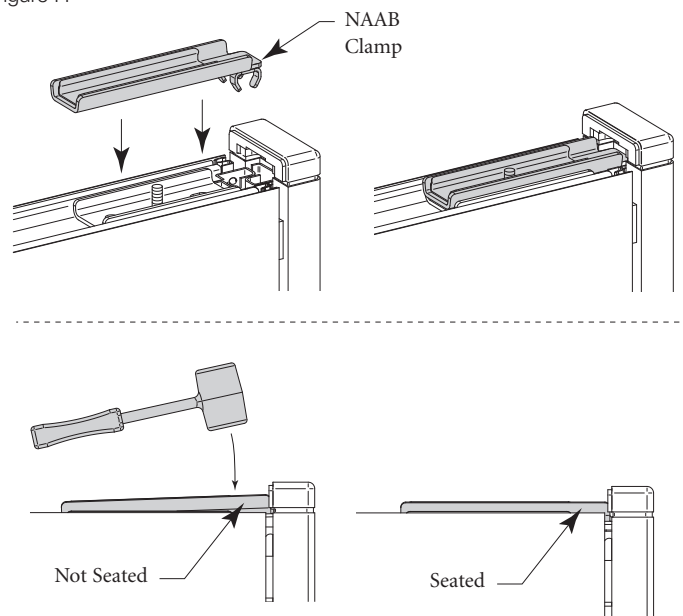
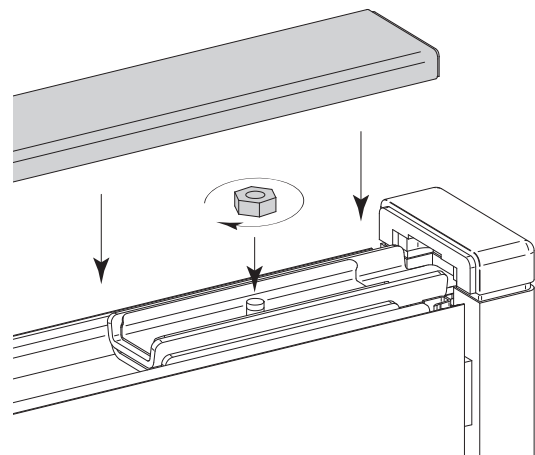

Figure I



Printed in U.S.A. © 2004 Kimball International, Inc. T 800.482.1818 F 812.482.8300

Proper product installation, in accordance with these instructions, is the responsibility of the installing agent. If you have any questions concerning these instructions, please call Kimball Office Customer Service.

Kimball[®]Office