

Fluent

Modesty Panels

Tools Required

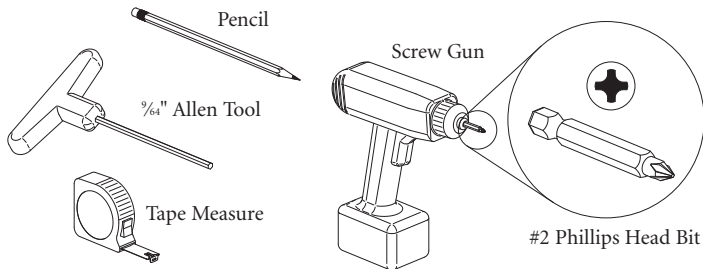

Package Contents

Resin Modesty

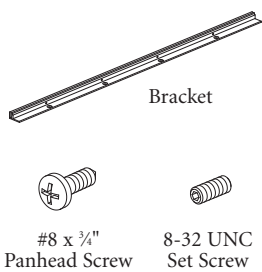

Fixed Modesty

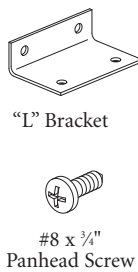

Technology Modesty

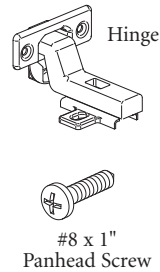

Installation

Resin Modesty panel:

1. Slide bracket onto resin modesty panel and tighten all set screws. (Figure A).
2. Align modesty panel centered left to right (approximately 1 1/2" on both sides), to dimension shown front to back with worksurface, measure and mark hole locations. (Figure B).
3. Drill pilot holes to insure modesty is mounted perpendicular to surface. Attach modesty panel assembly to worksurface as shown. (Figure C).

Figure A

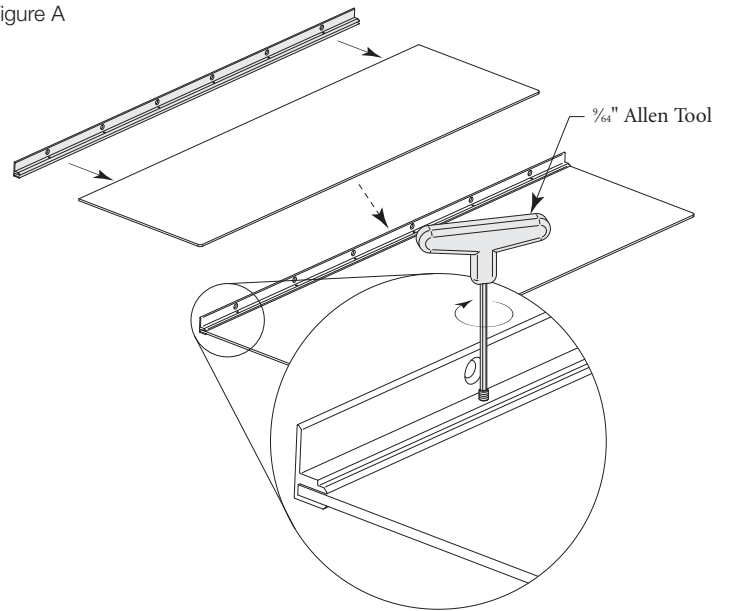

Figure B

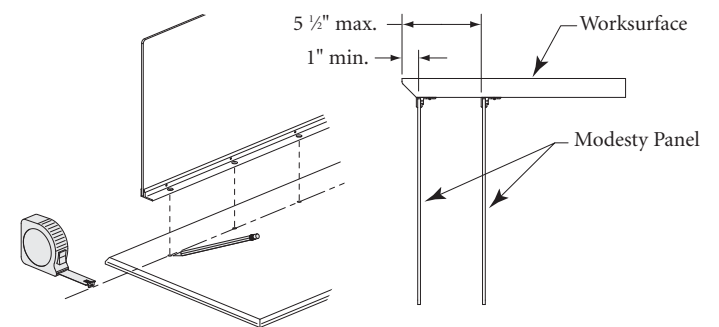
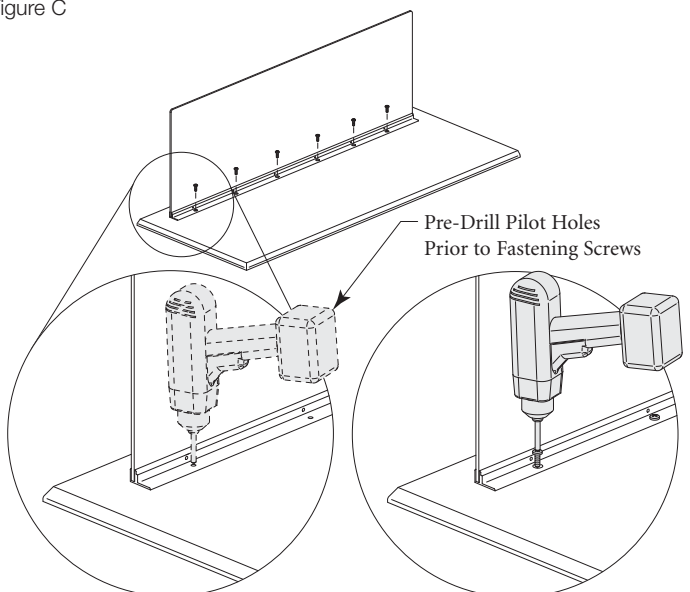

Figure C



Proper product installation, in accordance with these instructions, is the responsibility of the installing agent. If you have any questions concerning these instructions, please call Kimball Office Customer Service.

Kimball[®]Office

Fluent

Installation (continued)

Fixed Modesty panel:

1. Attach "L" brackets to modesty using pre-drilled holes. (Figure D).
2. Align modesty panel centered left to right, to dimension shown front to back with worksurface, measure and mark hole locations. (Figure E).
3. Drill pilot holes to insure modesty is mounted perpendicular to surface. Attach modesty panel assembly to worksurface as shown. (Figure F).

Technology Modesty Panel:

1. Align modesty panel centered left to right, to dimension shown front to back with bridge, measure and mark hinge location. (Figure G).
2. Drill pilot holes to insure modesty is mounted perpendicular to surface. Attach modesty panel with hinges to worksurface as shown. (Figure H).

Figure D

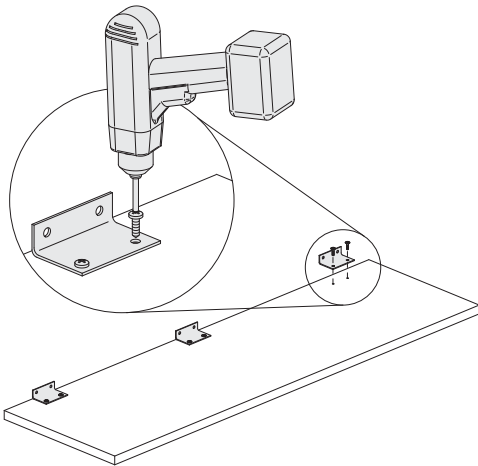

Figure E

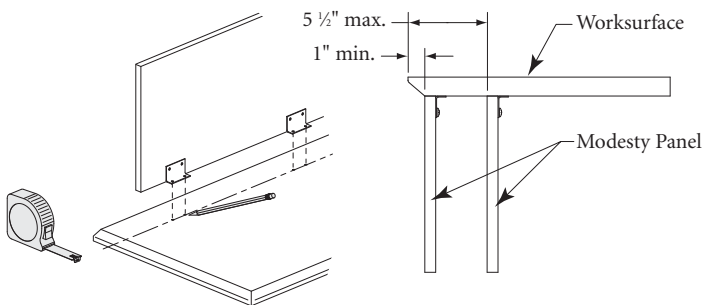

Figure F

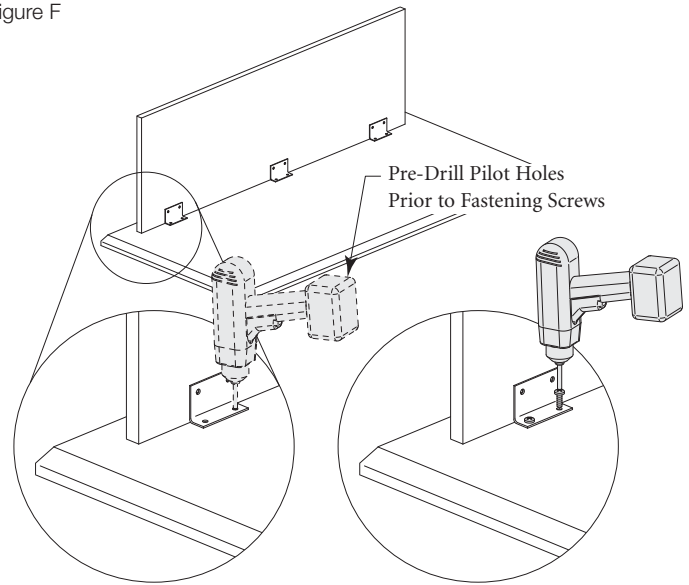

Figure G

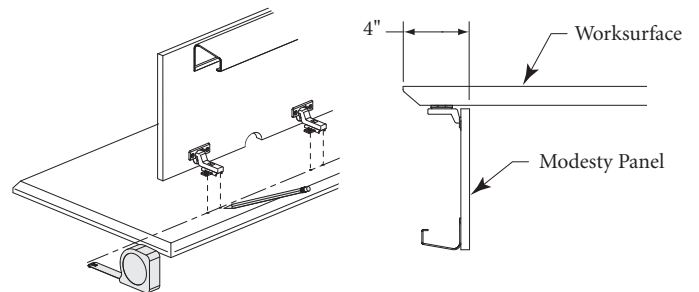
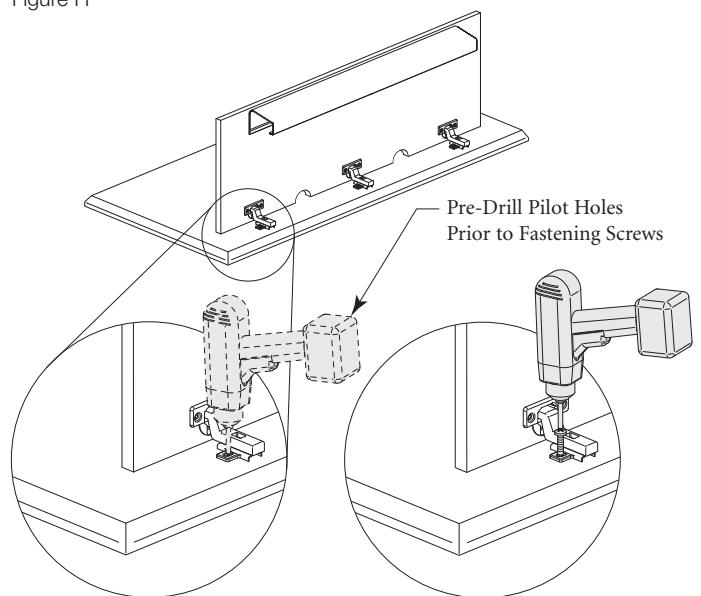

Figure H



Printed in U.S.A. © 2009 Kimball International, Inc. T 800.482.1818 F 812.482.8300

Proper product installation, in accordance with these instructions, is the responsibility of the installing agent. If you have any questions concerning these instructions, please call Kimball Office Customer Service.

Kimball Office