

Fluent

Reception Station

Tools Required

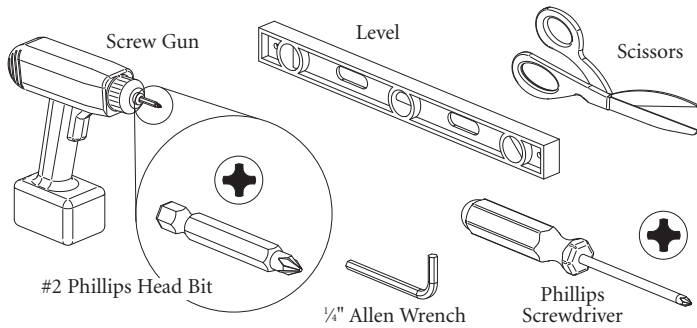

Package Contents

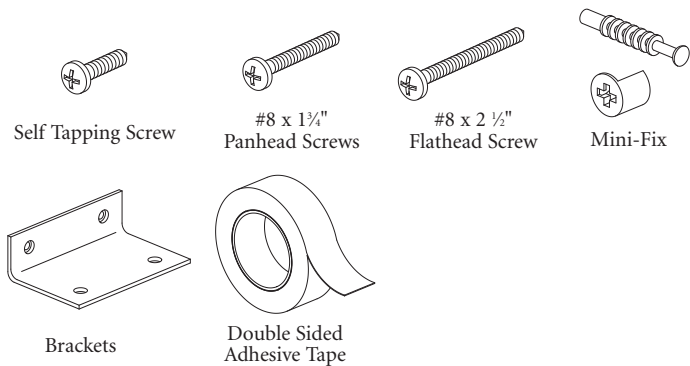

Reception Configurations

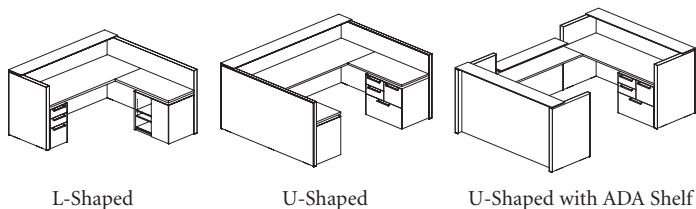

Installation

Note: It is recommended that at least two (2) persons be used assemble Reception Stations.

1. Insert mini-fix screws into each pre-drilled hole in all panels. (Figure A).
2. Fasten panels together using mini-fix screws. (Figure B).
3. Repeat Steps 1 and 2 for opposite side. (Figure C).

Figure A

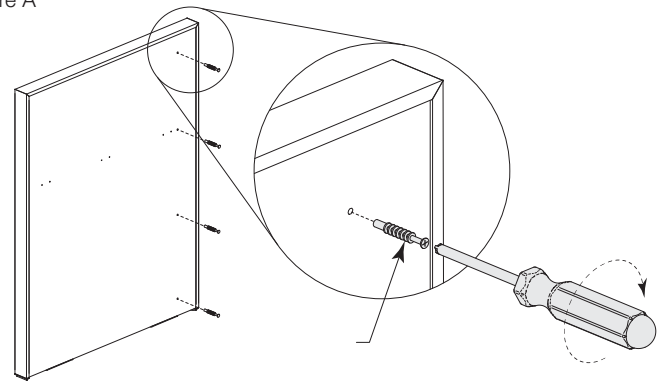

Figure B

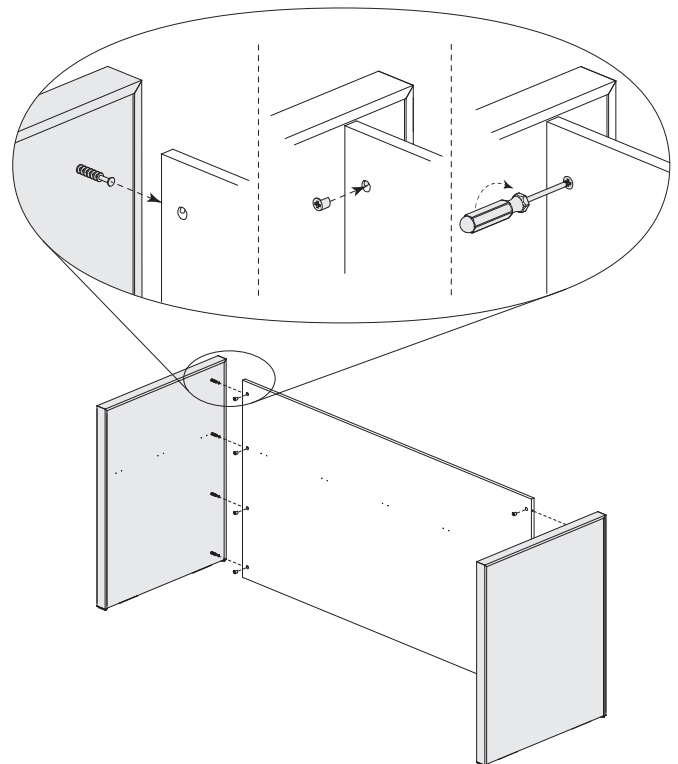
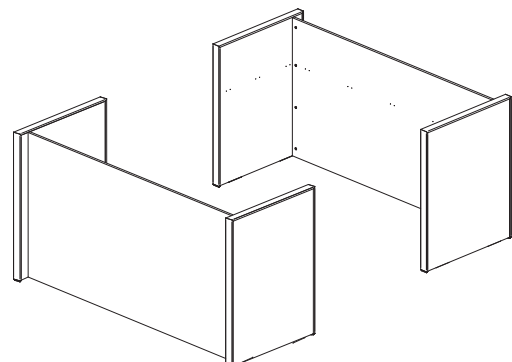

Figure C



Fluent

Installation (continued)

4. Turn the leveling glides fully “in” (counterclockwise) prior to leveling. Level the unit from front to back by first extending the glides (turn clockwise), then level the unit from side to side. Check adjustments by placing the level at positions shown. (Figure D).
5. Separate ADA shelf wall by sliding the two halves apart, disengaging the clips. (Figure E).
6. Fasten ADA wall to panels using self tapping screws. (Figure F).
7. Assemble ADA shelf wall by re-engaging clips. (Figure G)

Figure D

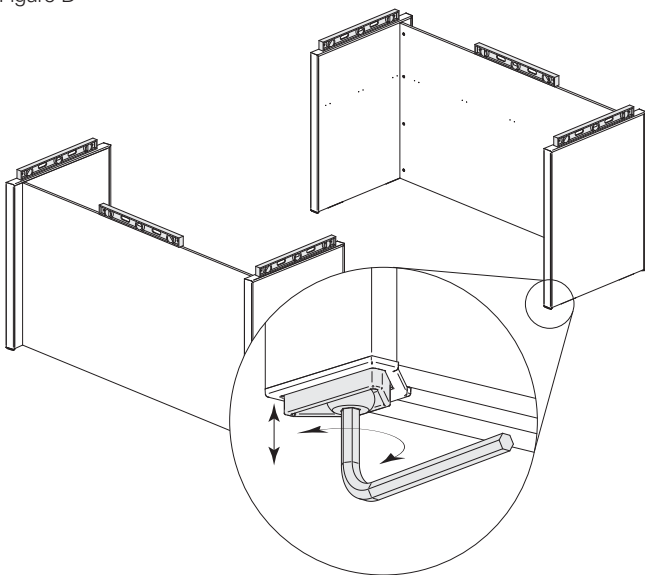

Figure E

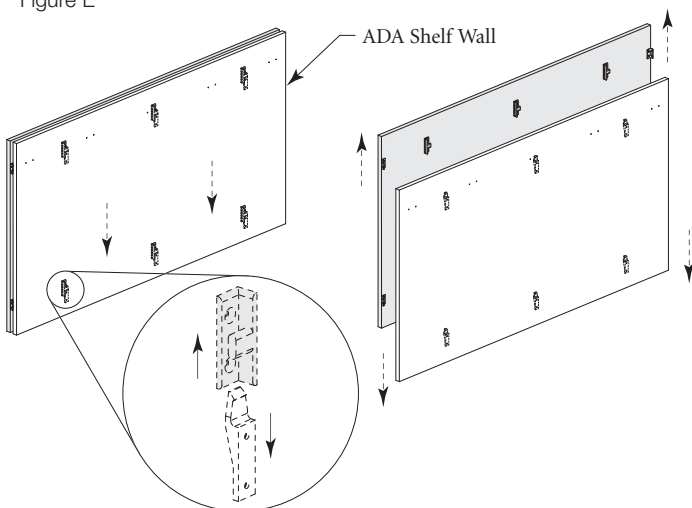

Figure F

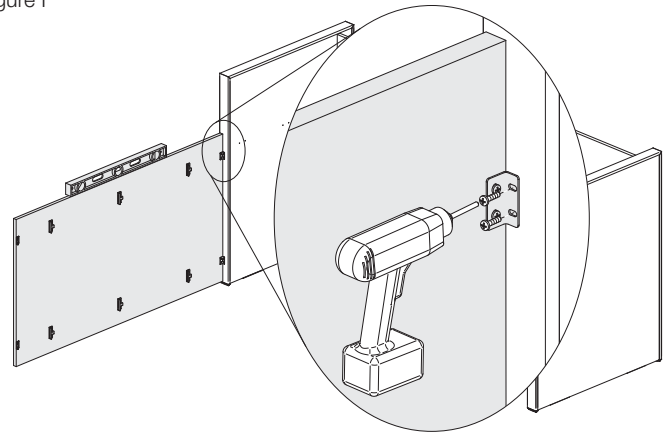
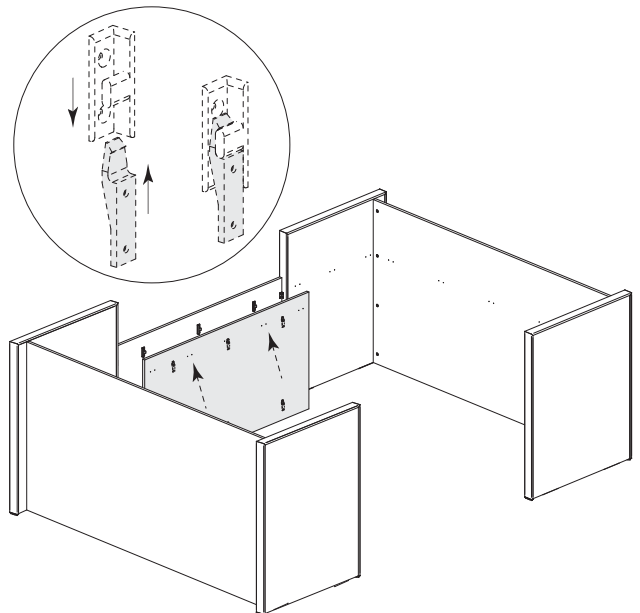

Figure G



Proper product installation, in accordance with these instructions, is the responsibility of the installing agent. If you have any questions concerning these instructions, please call Kimball Office Customer Service.

KimballOffice

Fluent

Installation (continued)

8. Fasten brackets to pre-drilled holes. (Figure H).
9. Position pedestals to be used. (Figure I).
10. Carefully lower worksurfaces into position. (Figure J).
11. Fasten worksurfaces to support brackets and pedestals. (Figure K).

Figure H

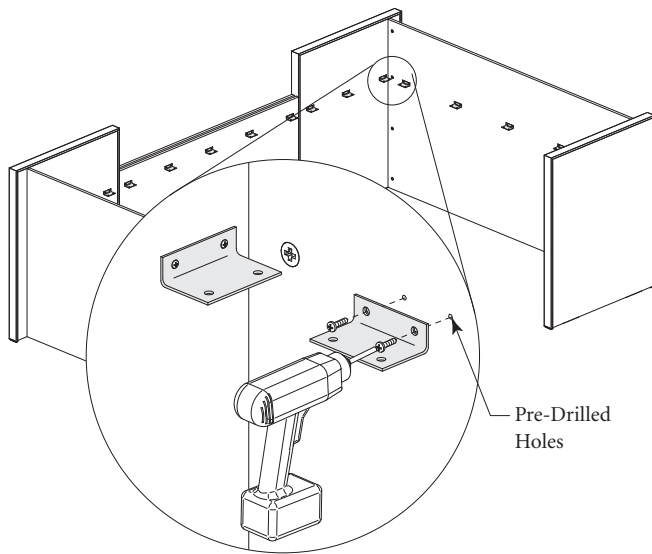

Figure I

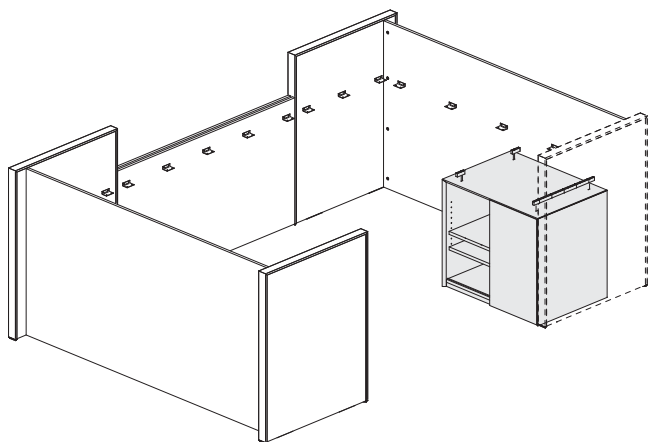

Figure J

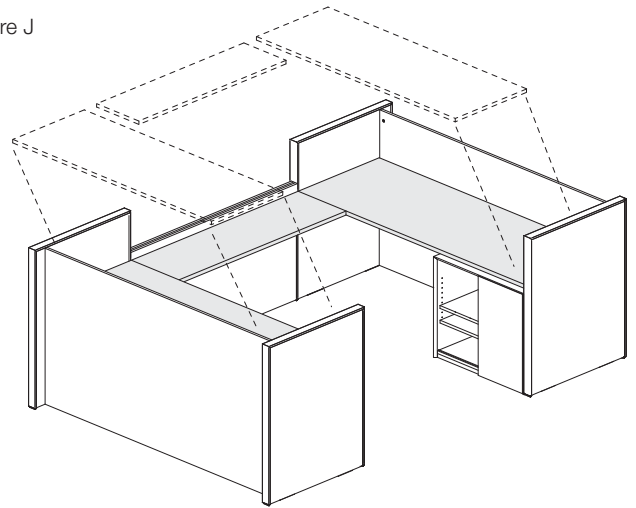
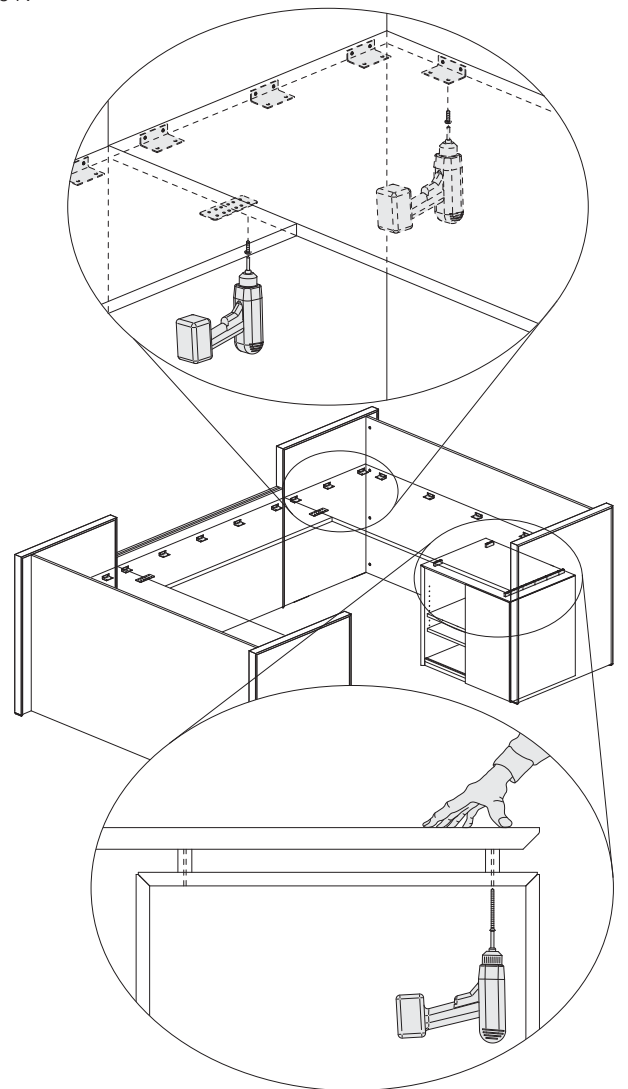

Figure K



Proper product installation, in accordance with these instructions, is the responsibility of the installing agent. If you have any questions concerning these instructions, please call Kimball Office Customer Service.

KimballOffice

Fluent

Installation (continued)

12. Attach shelf frames to panels. (Figure L).
13. Cut two strips of double-sided adhesive tape to run the length of short edge and six 12" strips to run the length of long edges. ADA shelves requires two 12" pieces centered on long edges, and two strips to run the length of short edge. (Figure M).
14. Carefully lower glass tops centered front-to-back and right-to-left of shelf frames. Check that glass top is squarely centered on frame and apply direct downward pressure for glass top to adhere. (Figure N).

Note: The shelf frame and glass top **MUST** be clean, dry, and free of any dirt or residue to assure adequate adhesion. (Figure B).

Caution: The tape is a very strong adhesive and bonds instantly to any surface it is applied to.

Figure L

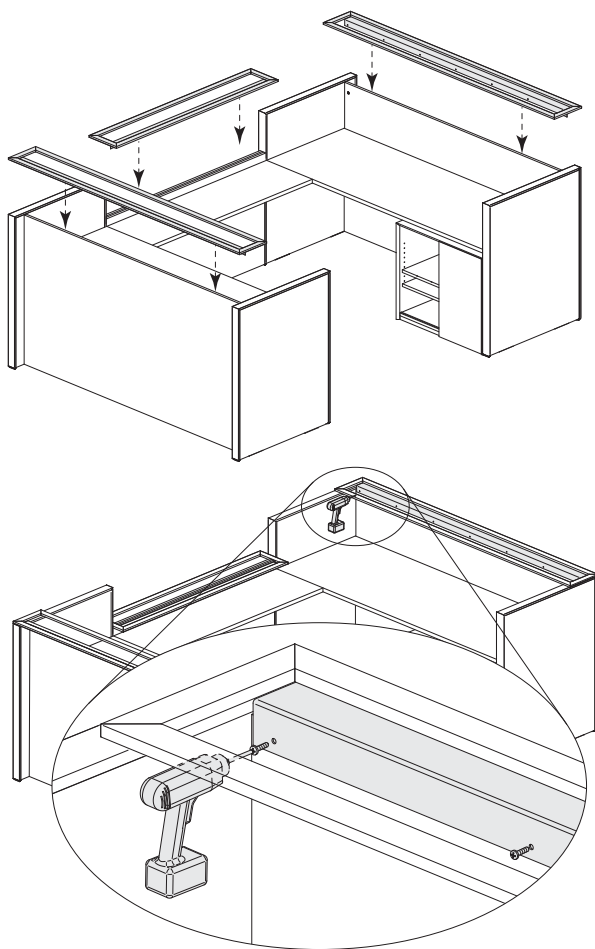

Figure M

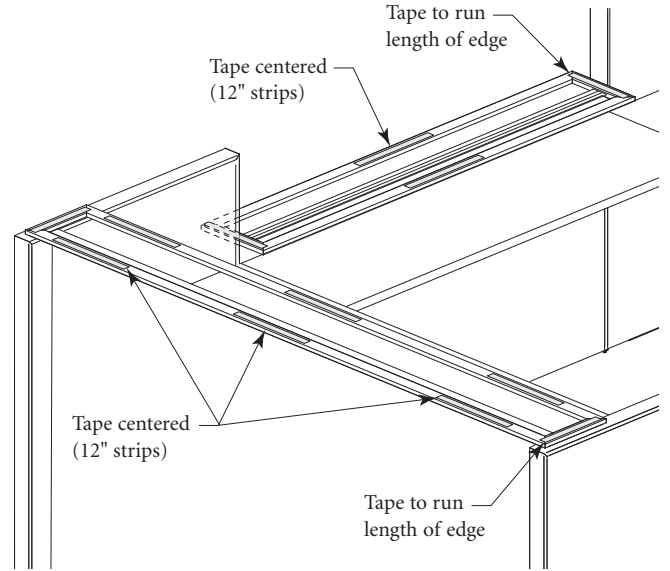
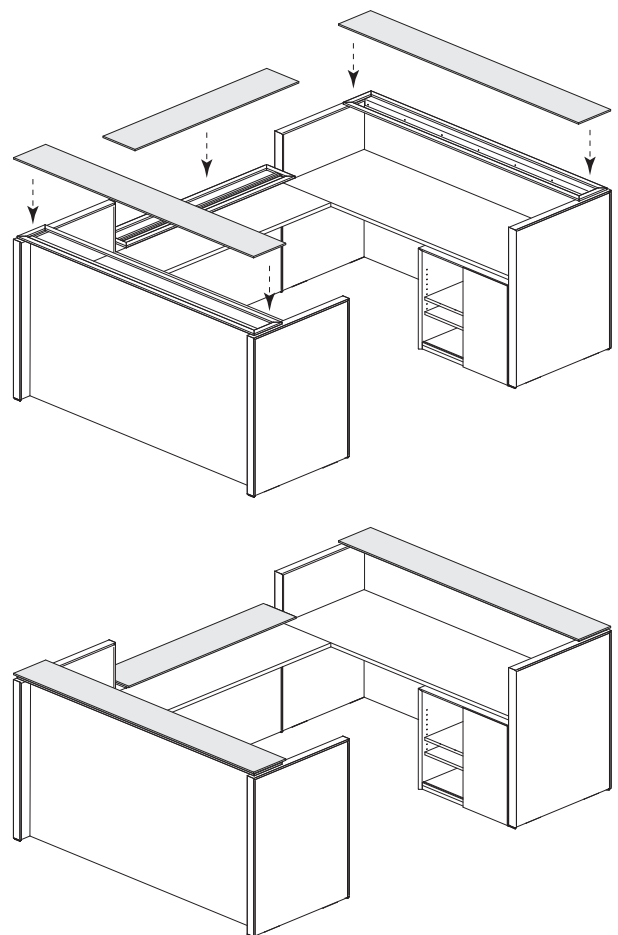

Figure N



Printed in U.S.A. © 2009 Kimball International, Inc. T 800.482.1818 F 812.482.8300

Proper product installation, in accordance with these instructions, is the responsibility of the installing agent. If you have any questions concerning these instructions, please call Kimball Office Customer Service.

Kimball[®]Office